



161 Littlebrook Avenue

, Slough, SL2 2PE

£185,000



Offered with vacant possession and ideally located for walking to Burnham 'ELIZABETH' Line station and Slough Trading Estate making this ideal investment purchase.

Well presented 1 bedroom first floor flat, offering 2 car park permit spaces, UPVC double glazing, modern shower room and fitted kitchen.

Viewings are highly recommended.



Entrance Hall

Security phone system, doors to lounge, shower room, bedroom, cupboard housing hot water tank and plumbing for washing machine. Built in storage cupboard.

L Shaped Lounge 15'7" x 13'1" (4.77 x 4.0)

Rear aspect double glazing and electric storage heater.

Kitchenette

Eye and base level units with square edged work surfaces, stainless steel sink unit, electric oven and hob with extractor fan. Space for small fridge and ceramic tile flooring.

Shower Room 7'1" x 5'11" (2.18 x 1.82)

Shower cubicle with thermostatic shower, concealed WC, vanity sink unit and ceramic tile flooring.

Bedroom 1 10'8" x 9'0" (3.27 x 2.76)

Front aspect double glazed window, electric wall heater and built in double wardrobe.

TENURE

90 Years Remaining

Service Charge to include buildings insurance £120.00 per calendar month

2 car parking permits will be issued with the property

Area Map

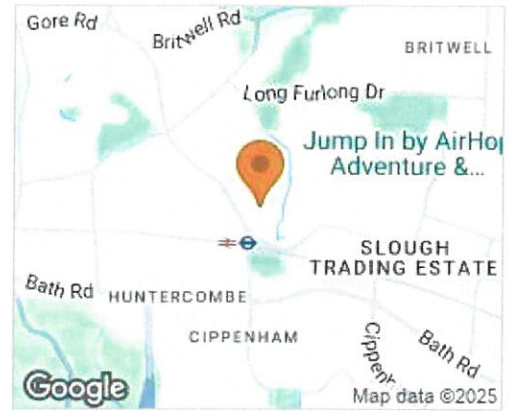

Floor Plans

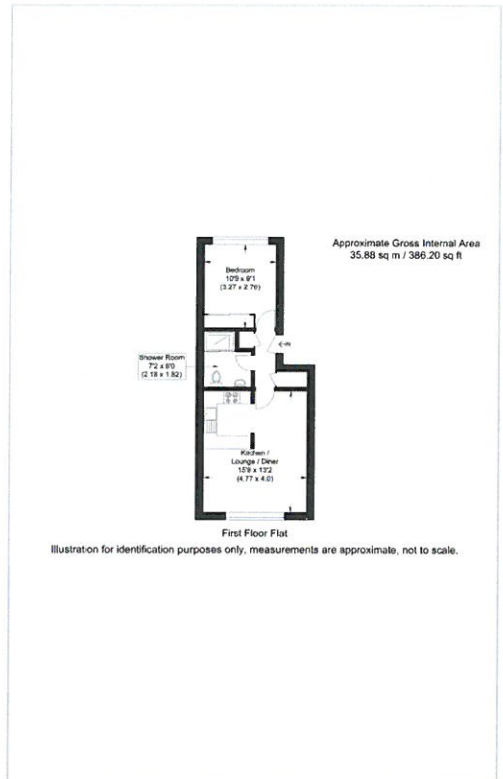

Energy Efficiency Graph

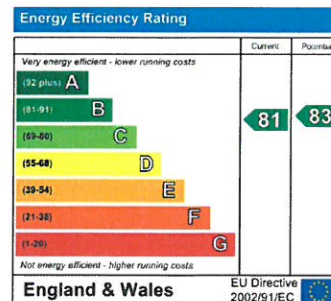

These particulars, whilst believed to be accurate are set out as a general outline only for guidance and do not constitute any part of an offer or contract. Intending purchasers should not rely on them as statements of representation of fact, but must satisfy themselves by inspection or otherwise as to their accuracy. No person in this firm's employment has the authority to make or give any representation or warranty in respect of the property.

422 Bath Road, Slough, Berkshire, SL1 6JA

Tel: 01628 661138 Email: cippenham@lambournecarmody.co.uk <https://www.lambournecarmody.co.uk>