



## Maple Mews, SW16

£400,000

Nestled amongst the trees, in a quiet and peaceful development, is this newly refurbished ground floor flat direct access to the communal gardens boasting three bedrooms, allocated parking, and pristine communal gardens. Being sold chain free, the flat is a perfect home or investment for any buyer looking in this beautiful area in South West London.

Maple Mews is located just off Hill House Road, this property is a short walk away from Streatham Common which houses the Rookery. There is also a great mix of shops, restaurants and pubs in the area as well as many transport links via Streatham and Streatham Common stations or buses into the city.

### Features

- Three Bedrooms
- Newly Refurbished
- Chain Free
- Allocated Parking
- Communal Grounds
- Quiet and Peaceful Location

# Maple Mews, London, SW16

## Ground Floor

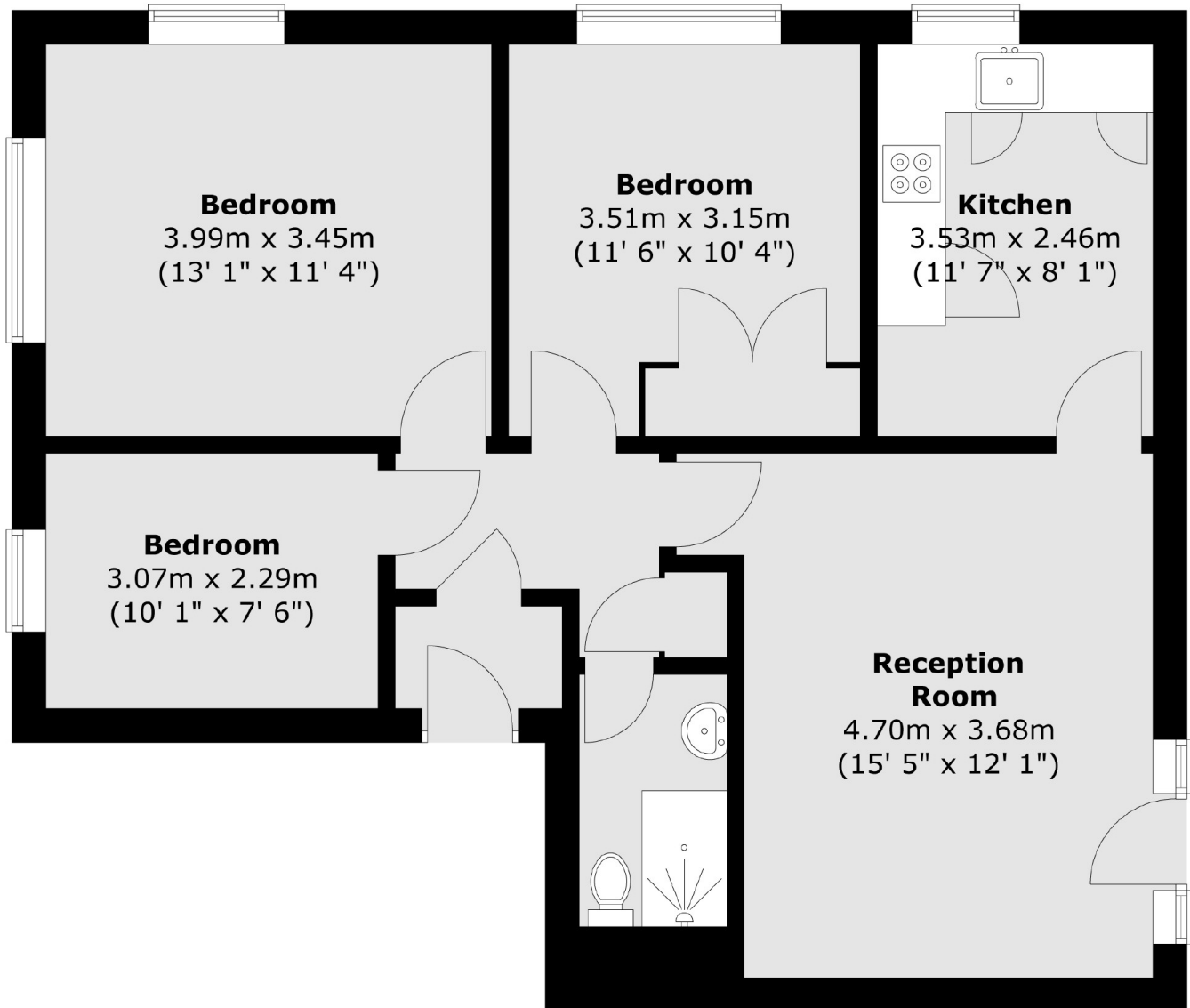

Total area (approx.) : 71.6 sq. m (771 sq. ft)