



Kempshott Road, SW16

£800,000

In need of refurbishment throughout this three bedroom detached home has incredible potential throughout. This home has a garage, off-street parking and large garden to the rear and has no onward chain.

Kempshott Road is within easy reach of both Streatham and Streatham Common stations providing links into the City and the West End. The amenities of Streatham High Road and the open spaces of the common are on the doorstep.

Features

- Three Bedrooms
- Detached
- Chain Free
- Off-Street Parking
- In need of refurbishment
- Large Garden

Kempshott Road, London, SW16

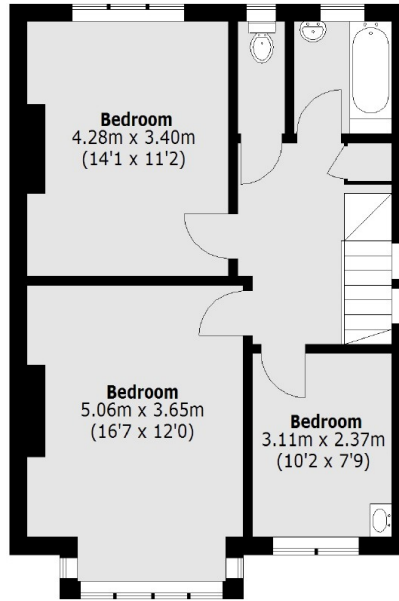

First Floor

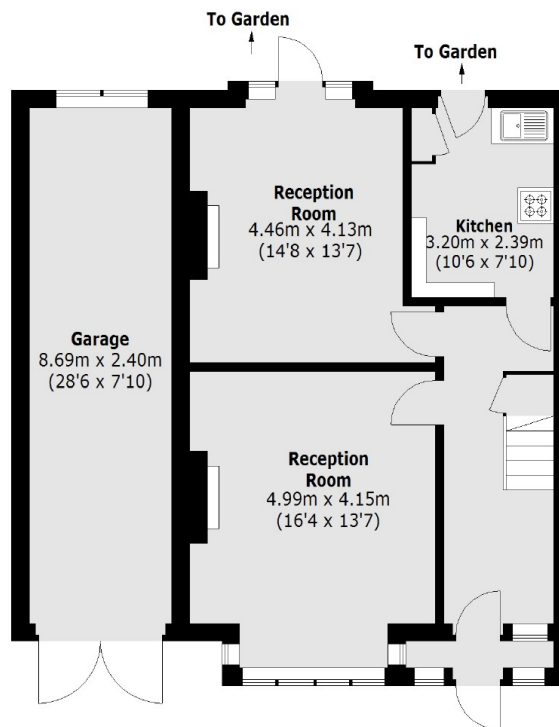

Ground Floor

Total area (approx.): 113.65 sq. m (1223 Sq. ft)
Garage: 21.32 sq. m (229 Sq. ft)