



Gaumont Place, SW2

£695,000

Dexters



Gaumont Place, SW2

A rare, lateral, four bedroom apartment with central private courtyard. This property is over 1,300sqft and features a spacious open-plan reception, large hallway with plenty of storage as well as four bedrooms. This home can be configured however you wish, one of the bedrooms could easily become a separate reception/snug or two can be used as studies if needed.

The property is in great condition throughout and has two bathrooms, with one being en-suite. Although not demised to the flat, there is also a large loft which can be accessed from the property that the current owners use for storage. There are also two underground car parking spaces with the property, concierge and on-site gym.

A range of amenities and facilities in Streatham Hill are on your doorstep with very frequent buses into Brixton, Clapham and surrounding areas. Links into Clapham Junction, Victoria and London Bridge are also nearby as well as open green spaces such as Tooting Bec Common.

Features

- Four Bedrooms
- Open Plan Living
- Central Private Courtyard
- Communal Grounds
- Gated Development
- Close to Station



Gaumont Place, London, SW2

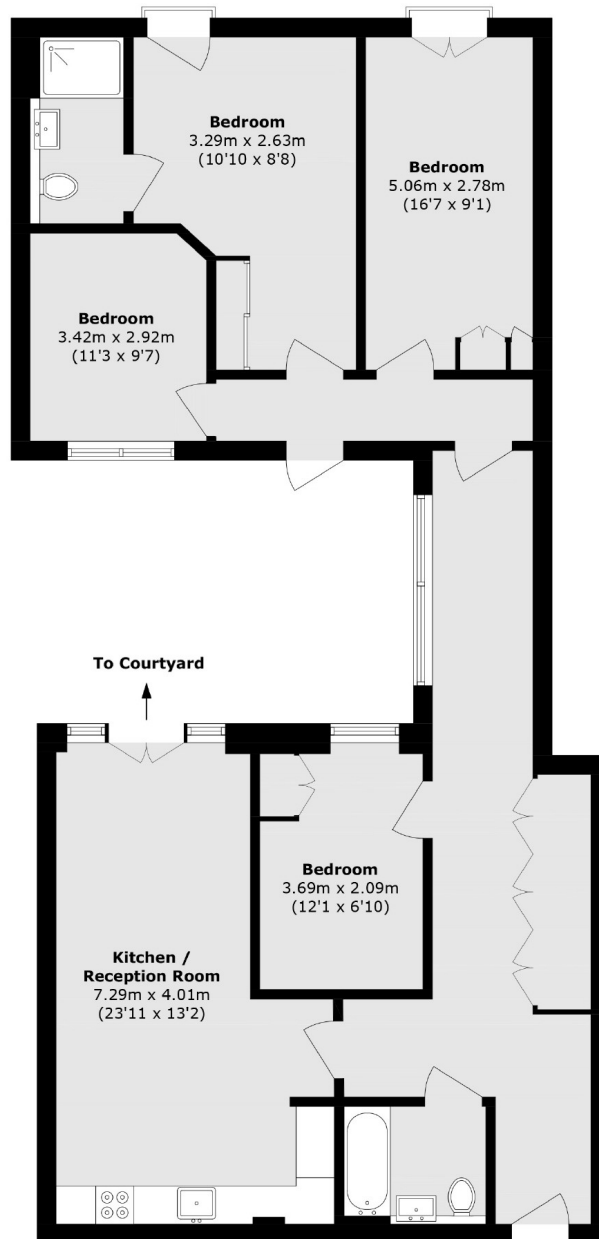

Total area (approx.): 120.8 sq. m (1300.3 sq. ft)

Dexters

Streatham
105 Streatham Hill
London
SW2 4UG
Sales
020 8674 7400

Energy Rating: B. We aim to make our particulars both accurate and reliable. However they are not guaranteed; nor do they form part of an offer or contract. If you require clarification on any points then please contact us, especially if you're traveling some distance to view. Please note that appliances and heating systems have not been tested and therefore no warranties can be given as to their good working order.

 **RICS** | Regulated
Estate Agent
and Letting Agent

[dexters.co.uk](https://www.dexters.co.uk)