



**Thornton Avenue, SW2**  
**£625,000**

**Dexters**



## Thornton Avenue, SW2

Located between Balham and Streatham this two bedroom garden flat features a large private garden and home office. With high ceilings and large bay window this living space is open to the kitchen and feels secluded due to the mature front garden.

There are two bedrooms with modern shower room and access onto the large decking space. Stairs down to the large lawn area is full of trees and mature shrubs leading down to the garden room which has views over the garden and is the perfect space to work from home. The property also comes with a share in the freehold.

Thornton Avenue is positioned in the highly desirable Telford Park conservation area, which is known for its grand period properties and great location bordering Balham, Streatham and Tooting Bec Common. Great transport links, with Balham and Streatham Hill stations only a walk away.

### Features

- Two Bedrooms
- Garden Office
- Large Garden
- Open-Plan Living
- Great Location
- Modern throughout







# Thornton Avenue, London, SW2

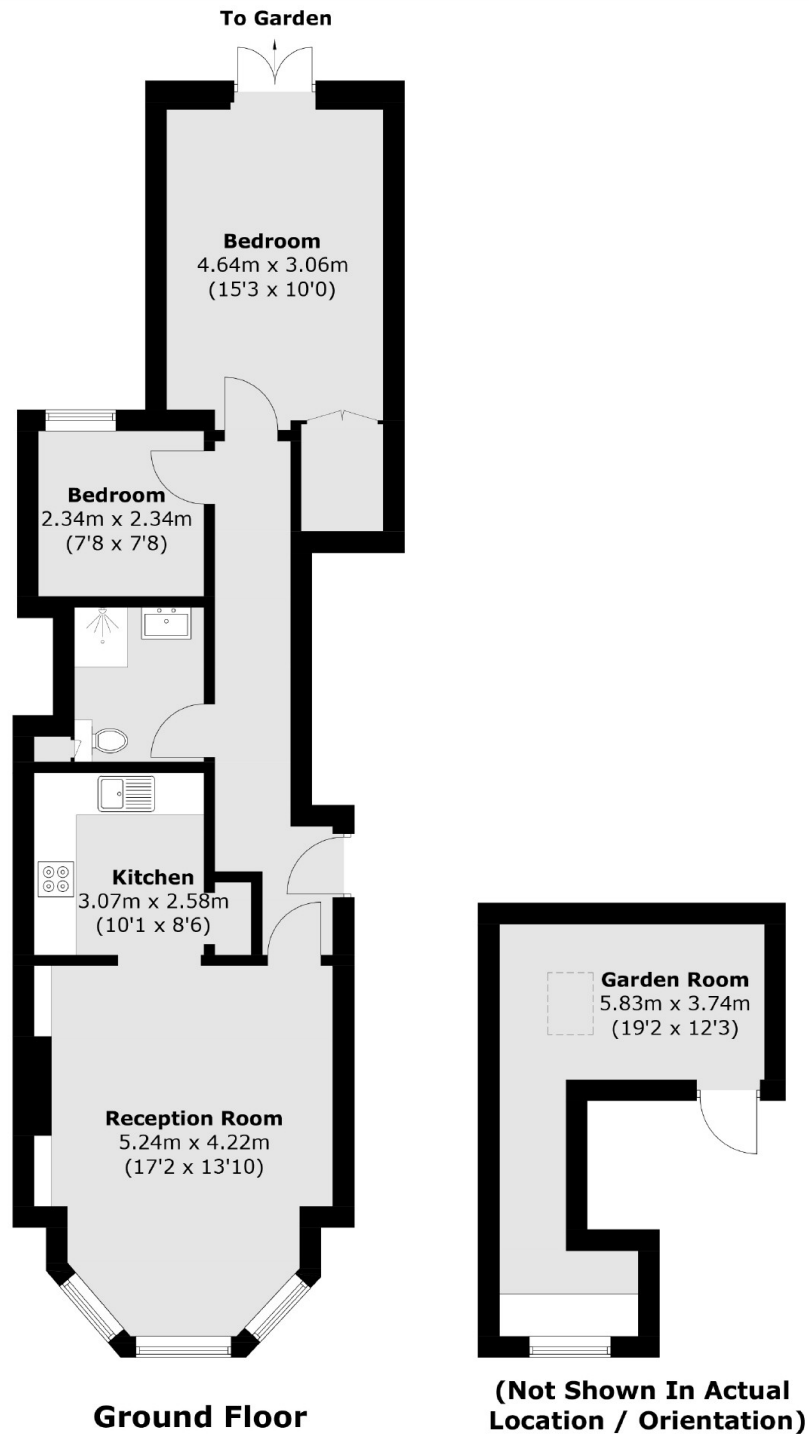

Total area (approx.): 63.2 sq. m (680.3 sq. ft)  
Garden Room: 13.0 sq. m (139.9 sq. ft)

## Dexters

Streatham  
105 Streatham Hill  
London  
SW2 4UG  
Sales  
020 8674 7400

Energy Rating: D. We aim to make our particulars both accurate and reliable. However they are not guaranteed; nor do they form part of an offer or contract. If you require clarification on any points then please contact us, especially if you're traveling some distance to view. Please note that appliances and heating systems have not been tested and therefore no warranties can be given as to their good working order.

 **RICS** | Regulated  
Estate Agent  
and Letting Agent

dexters.co.uk