



## Leigham Close, SW16

£1,600 Per calendar month

This light and spacious top floor apartment is quietly positioned to the rear of a popular development close to Streatham Hill, offering a large reception, separate kitchen and double bedroom.

Spa View is positioned within a quiet cul-de-sac whilst having the convenience of being located within close proximity of Streatham High Road with its variety of bars, restaurants and leisure facilities. Mainline trains can be found at Streatham Hill.

### Features

- Top Floor
- Double Bedroom
- Large Reception
- Separate Kitchen
- Free Parking
- Prime Location

Leigham Close,  
London, SW16

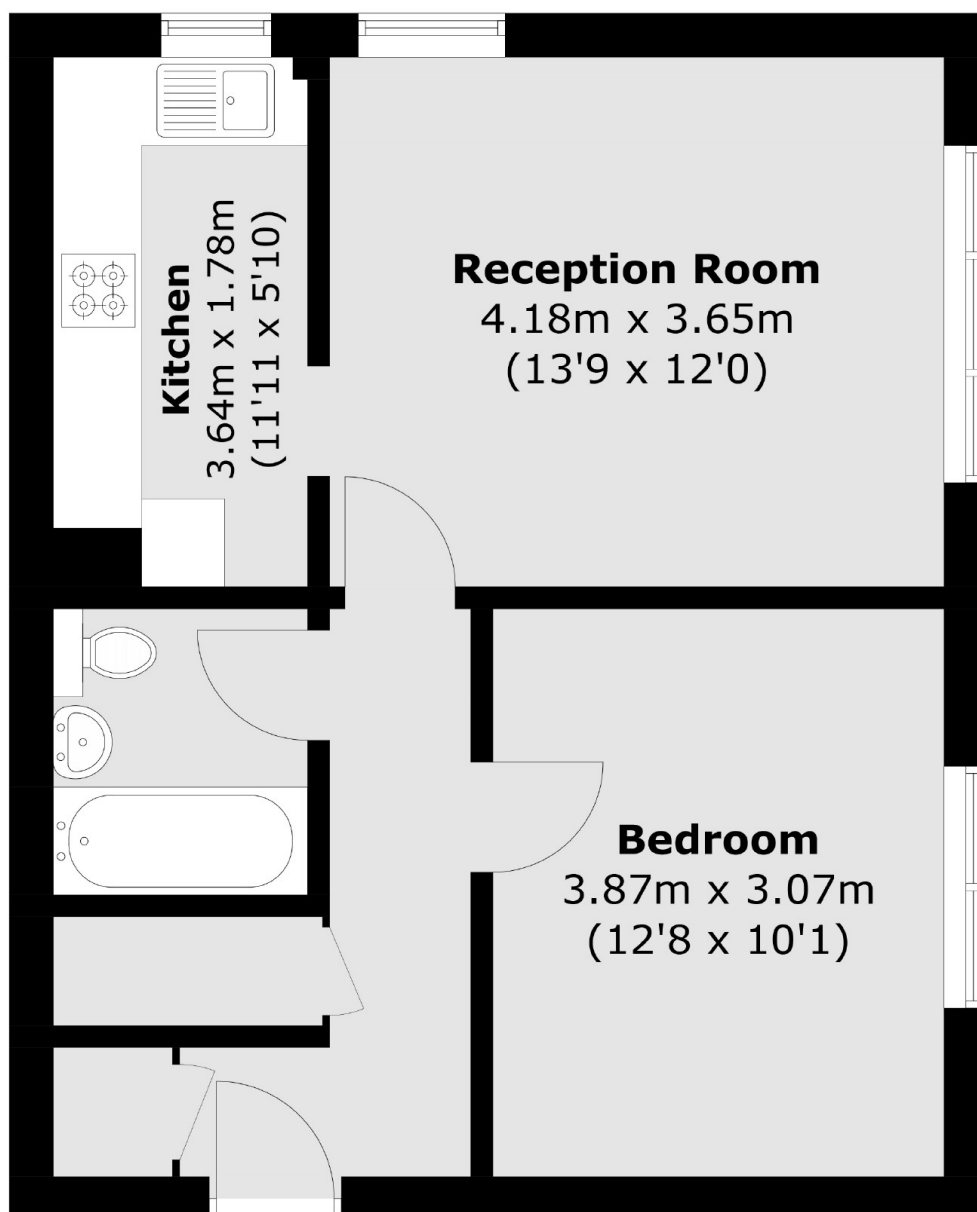

Total area (approx.): 46.4 sq. m (499.4 sq. ft)