



Pathfield Road, SW16

£2,100 Per calendar month

This bright and airy two double bedroom ground floor flat is based in a period property on a quiet residential road just off Streatham High Road. The property has a great open plan entertaining space which leads straight on to the private garden.

Pathfield Road is moments from Streatham Common and Streatham Common Station, as well as all major bus routes. Along with all the local shops, bars, cafés and restaurants.

Features

- Two Double Bedrooms
- Ground Floor Flat
- Private Garden
- Close to Station
- Close to Shops
- Close to Park

Pathfield Road, London, SW16

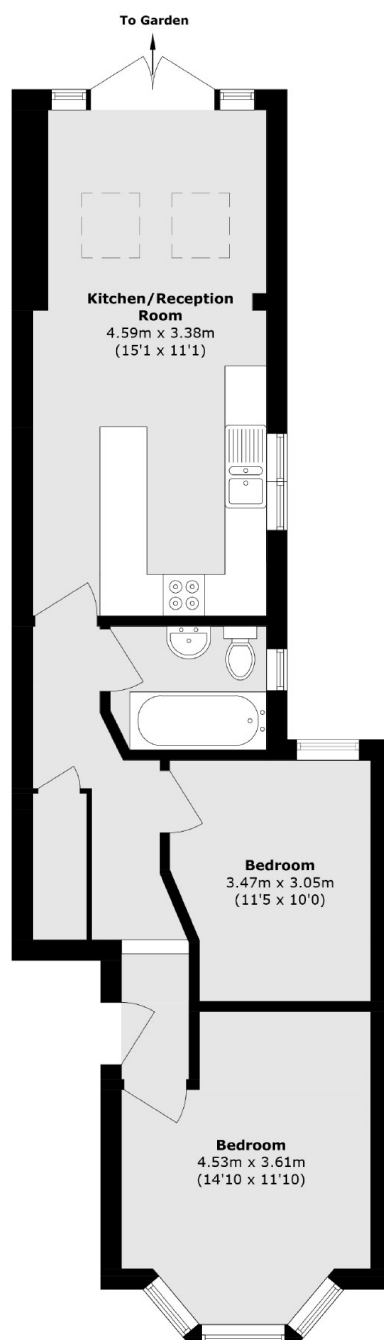

Total area (approx.): 76.8 sq. m (826.6 sq. ft)

Dexters

Streatham
105 Streatham Hill
London
SW2 4UG
Lettings
020 8674 8400

Energy Rating: D. We aim to make our particulars both accurate and reliable. However they are not guaranteed; nor do they form part of an offer or contract. If you require clarification on any points then please contact us, especially if you're traveling some distance to view. Please note that appliances and heating systems have not been tested and therefore no warranties can be given as to their good working order.

 **RICS** | Regulated
Estate Agent
and Letting Agent

[dexters.co.uk](https://www.dexters.co.uk)