



Streatham High Road, SW16

£625,000

Dexters



Streatham High Road, SW16

At just under 1,300sqft is this three bedroom lateral apartment with large terrace. With a full open plan living room this home has a large reception with kitchen just off it as well as sliding doors onto the terrace area. All three bedrooms are large doubles and there are two bathrooms that have been fully renovated by the current owner, one being an en-suite.

The sunny terrace spans the width of this modern property and can be accessed via all bedrooms and the living space. There is plenty of storage throughout and this property is being offered with no onward chain.

Picture House is located to the rear of this converted cinema. The property is situated right in the hub of Streatham Hill providing a range of shops and restaurants and great transport links via Clapham Junction into London Victoria. There are also a range of buses linking to Brixton.

Features

- Three Double Bedrooms
- Great Location
- Close to Station
- Chain Free
- Large terrace
- Two Bathrooms



Streatham High Road, London, SW16

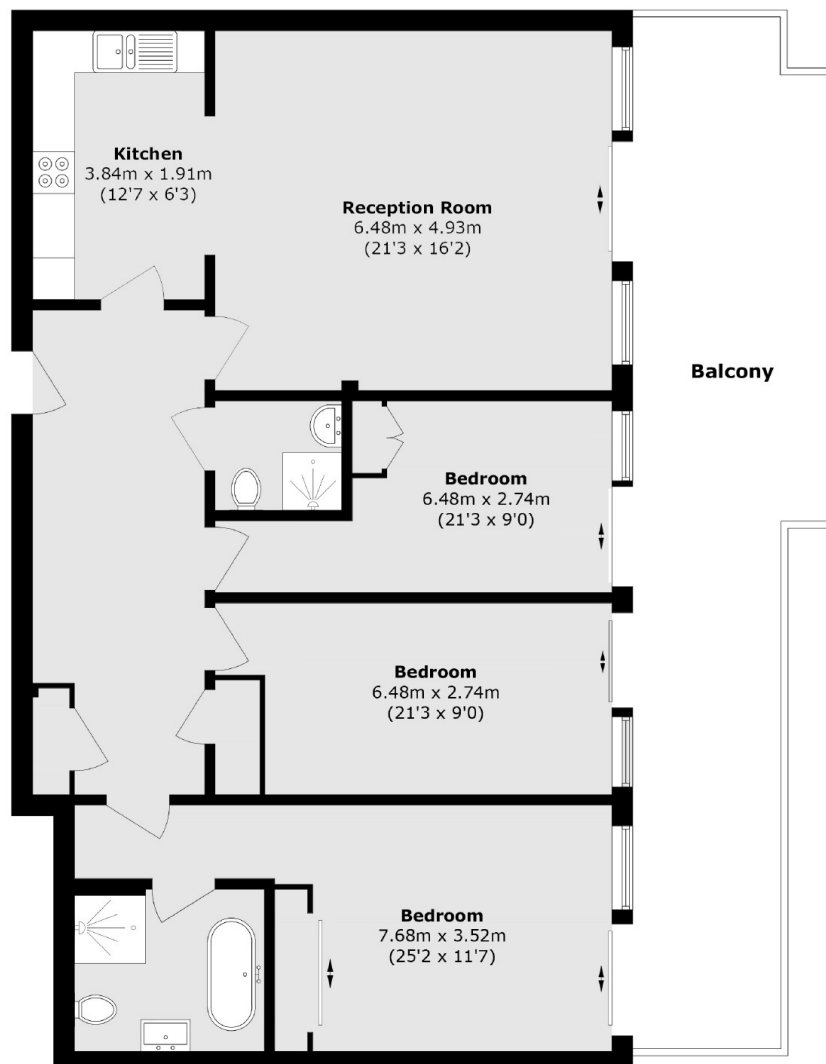

Total area (approx.): 118.6 sq. m (1276.6 sq. ft)

Balcony area (approx.): 35.9 sq. m (386.4 sq. ft)

Dexters

Streatham
105 Streatham Hill
London
SW2 4UG
Sales
020 8674 7400

Energy Rating: D. We aim to make our particulars both accurate and reliable. However they are not guaranteed; nor do they form part of an offer or contract. If you require clarification on any points then please contact us, especially if you're traveling some distance to view. Please note that appliances and heating systems have not been tested and therefore no warranties can be given as to their good working order.

 **RICS** | Regulated
Estate Agent
and Letting Agent

[dexters.co.uk](https://www.dexters.co.uk)