



Westfield Avenue, CR2

£2,500 Per calendar month

A three bedroom detached bungalow situated on a quite tree lined street that overlooks Mitchley hills. The property has three double bedrooms, two bathrooms, a great open plan entertaining space, large private garden and off street parking.

Westfield Avenue is a desirable road in South Croydon/ Purley borders, which is walking distance to Riddlesdown station.

Features

- Three Bedroom House
- Two Bathrooms
- Open Plan Reception
- Off Street Parking
- Quiet Tree Lined Street
- Large Private Garden

Westfield Avenue, South Croydon, CR2

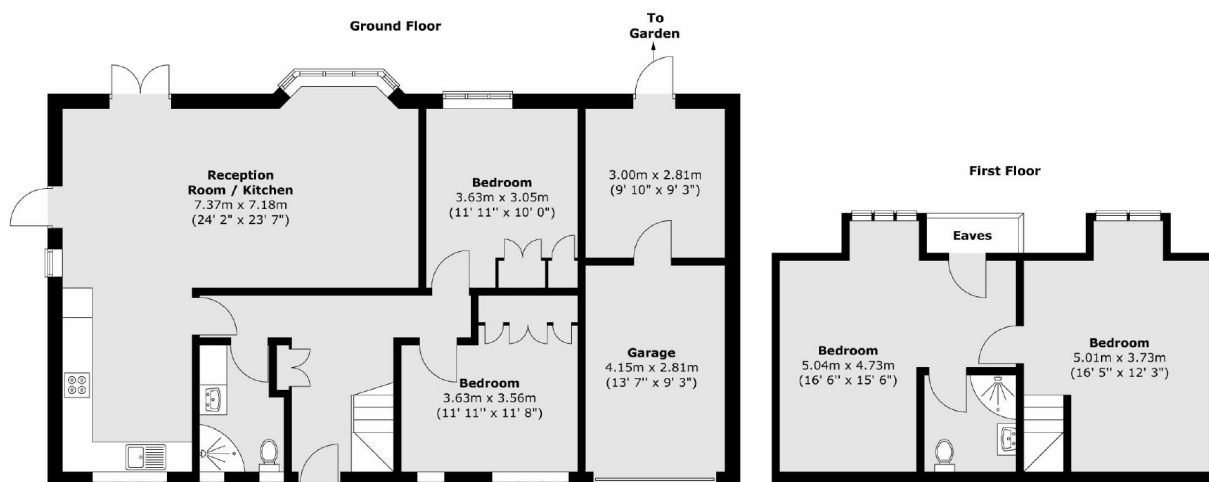

Total area (approx.) : 136.6 sq. m (1470 sq. ft)
(Excluding eaves)

Dexters

Streatham
105 Streatham Hill
London
SW2 4UG
Lettings
020 8674 8400

Energy Rating: C. We aim to make our particulars both accurate and reliable. However they are not guaranteed; nor do they form part of an offer or contract. If you require clarification on any points then please contact us, especially if you're traveling some distance to view. Please note that appliances and heating systems have not been tested and therefore no warranties can be given as to their good working order.

 **RICS** | Regulated
Estate Agent
and Letting Agent

[dexters.co.uk](https://www.dexters.co.uk)