



## Upper Tulse Hill, SW2

### £270,000

A one bedroom purpose built apartment in a quiet and conveniently located residential development. Internal accommodation includes a recently refurbished and fully fitted kitchen. Large reception room, bright double bedroom, and bathroom with three piece suite. Numerous selling features include, being offered to the market chain free, communal parking, communal gardens and a garage.

Upper Tulse Hill is a residential side street nestled in between Streatham Hill & Brixton Hill and benefits from a selection of local amenities and regular bus routes into the city.

### Features

- One Double Bedrooms
- Modern Kitchen
- Chain Free
- Communal Grounds
- Long Lease
- Garage

# Upper Tulse Hill, London, SW2

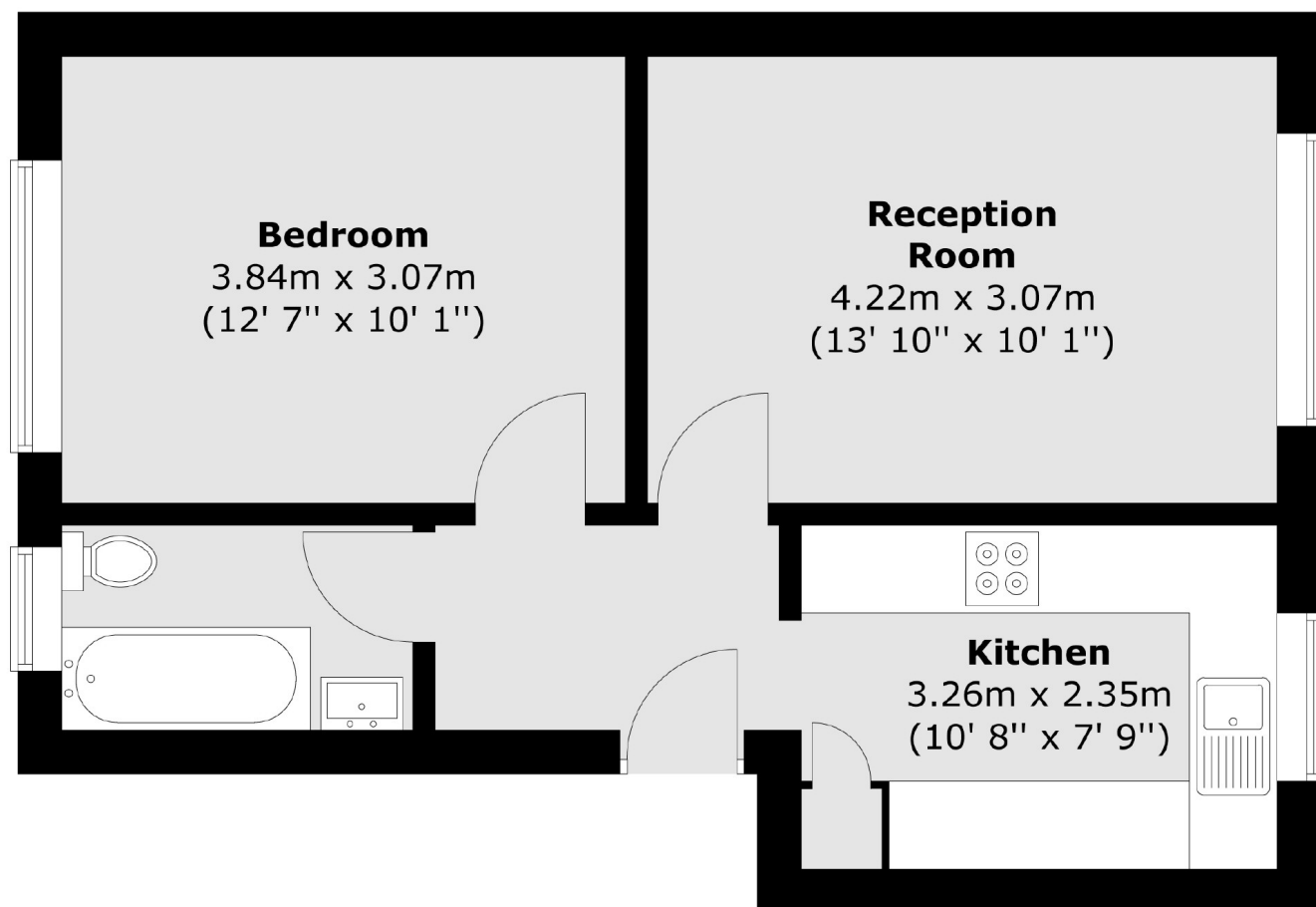

Total area (approx.) : 41.4 sq. m (446 sq. ft)