



Leigham Close, SW16

£280,000

This light and spacious top floor apartment is quietly positioned to the rear of a popular development close to Streatham Hill. Accommodation benefits dual aspect reception, separate kitchen, spacious double bedroom, plenty of storage space in the loft and great views.

Spa View is positioned within a quiet cul-de-sac whilst having the convenience of being located within close proximity of Streatham High Road with its variety of bars, restaurants and leisure facilities. Mainline trains can be found at Streatham Hill.

Features

- Top Floor
- Double Bedroom
- Dual Aspect Reception
- Parking Space
- Separate Kitchen
- No Onward Chain

Leigham Close, London, SW16

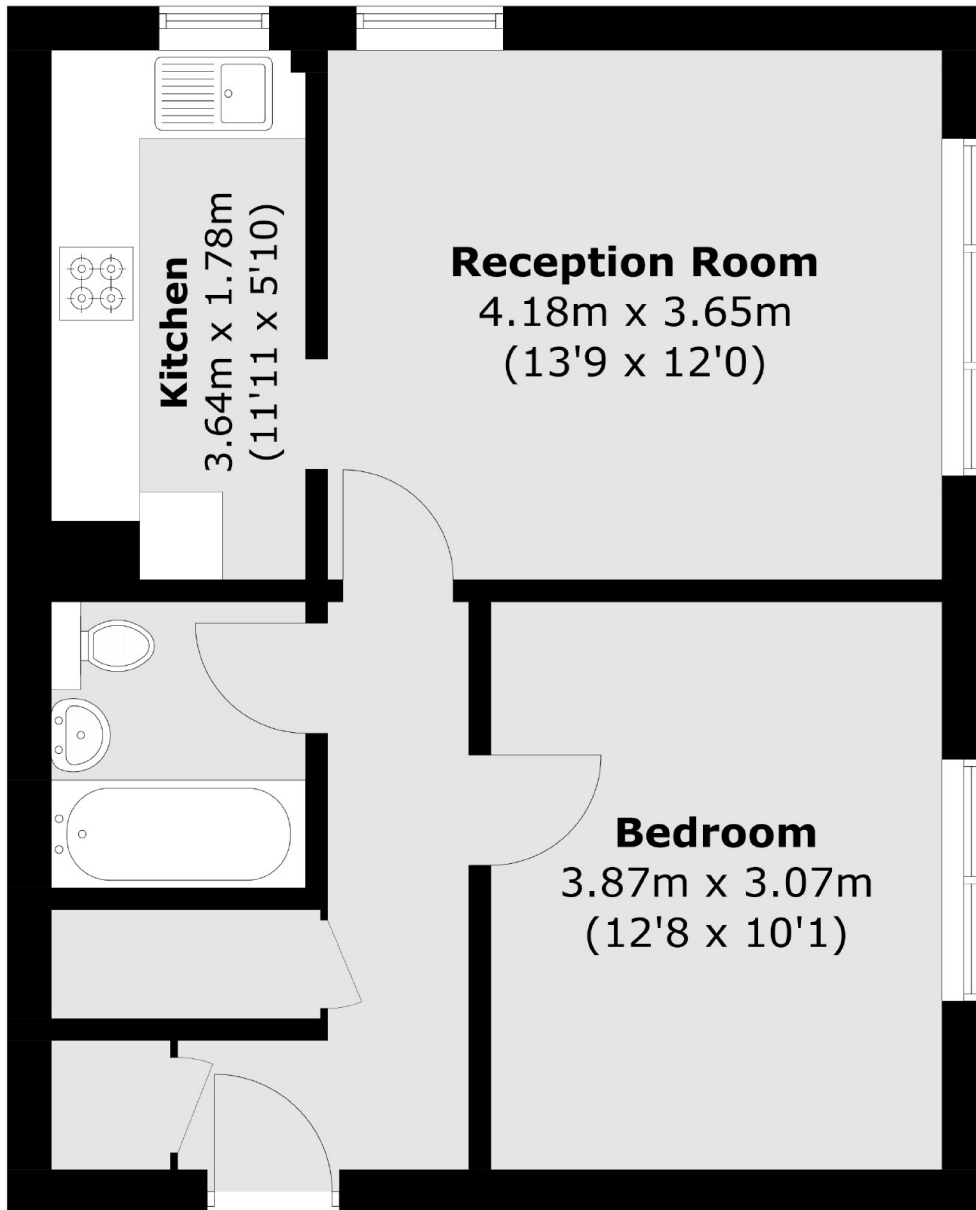

Total area (approx.): 46.4 sq. m (499.4 sq. ft)

Dexters

Streatham
105 Streatham Hill
London
SW2 4UG
Sales
020 8674 7400

Energy Rating: C. We aim to make our particulars both accurate and reliable. However they are not guaranteed; nor do they form part of an offer or contract. If you require clarification on any points then please contact us, especially if you're traveling some distance to view. Please note that appliances and heating systems have not been tested and therefore no warranties can be given as to their good working order.

 **RICS** | Regulated
Estate Agent
and Letting Agent

[dexters.co.uk](https://www.dexters.co.uk)