

Knights Hill, SE27

£400,000

A newly built two-bedroom maisonette apartment situated within a gated mews. There is a high specification throughout, with energy efficiency in mind including an air source heat pump. There is plenty of outside space with a good sized balcony.

Knights Hill is a short walk away from West Norwood Station offering connections to London Victoria and London Bridge. Shops, and restaurants are all located on West Norwood High Street and Streatham Common is a great park to enjoy nearby.

Features

- Private Gated Mews
- Two Bedrooms
- High Specification Throughout
- Balcony/Terrace
- Share Of The Freehold

Knights Hill, West Norwood, SE27

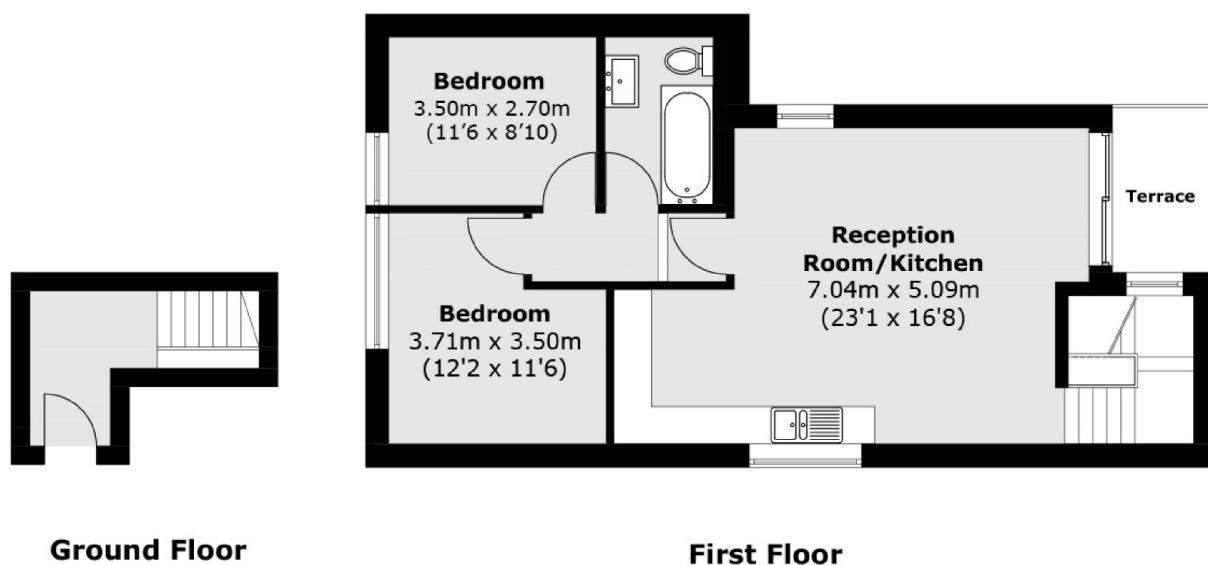

Total internal area (approx.): 75.6 sq. m (813.7 sq. ft)
Terrace area (approx.): 4.5 sq. m (48.4 sq. ft)