



## Rockhampton Road, SE27

### £675,000

In need of modernisation, this three bedroom semi-detached family home is coming to the market with no onward chain. Comprising of two receptions, separate kitchen, utility room and large garden on the ground level. With three double bedrooms with a family bathroom on the first floor.

Rockhampton Road is a quiet leafy road located just off Leigham Court Road. It's within easy reach of Norwood High Street and equidistant between West Norwood and Streatham Hill mainline Stations.

### Features

- No Onward Chain
- Over 1,000 Sq Ft
- Semi-Detached
- Side Access
- Double Reception Room
- Three Bedrooms

# Rockhampton Road, London, SE27

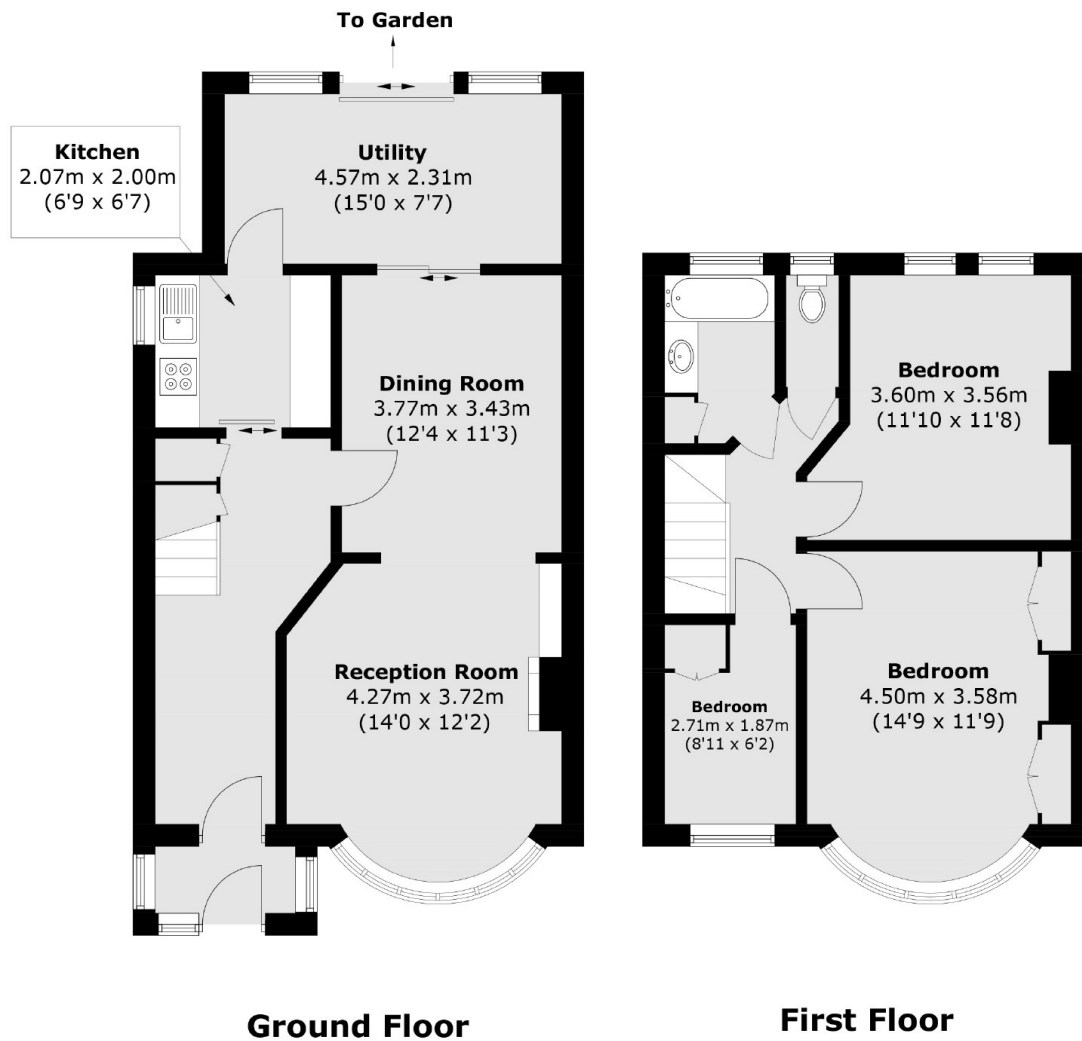

Total area (approx.): 99.0 sq. m (1,065.5 sq. ft)