



**Leithcote Path, SW16**  
**£450,000**

**Dexters**



## Leithcote Path, SW16

Renovated by the current owners, this three double bedroom spacious apartment is a perfect purchase. With a modern kitchen and bathroom, this home has been stylishly presented, creating a turn-key property. The three double bedrooms provide flexible living accommodation, whether that be bedrooms, study space or a further living area.

This home has a bright reception with space for a large dining table and lounging area with views over the south-facing communal grounds. This property also comes with an off-street parking space and access to secure bike storage.

Leithcote Path is located just off Leigham Court Road. Streatham Hill Station is near which offers links to London Victoria via Clapham Junction. Tulse Hill Station is also within walking distance and provides regular train services on the Thameslink service to London Blackfriars via London Bridge. Streatham High Road offers a wide range of shops, restaurants and supermarkets.

### Features

- Three Double Bedrooms
- Newly renovated
- Bright Reception
- Off-Street Parking Space
- Separate Kitchen
- Communal Grounds





# Leithcote Path, London, SW16

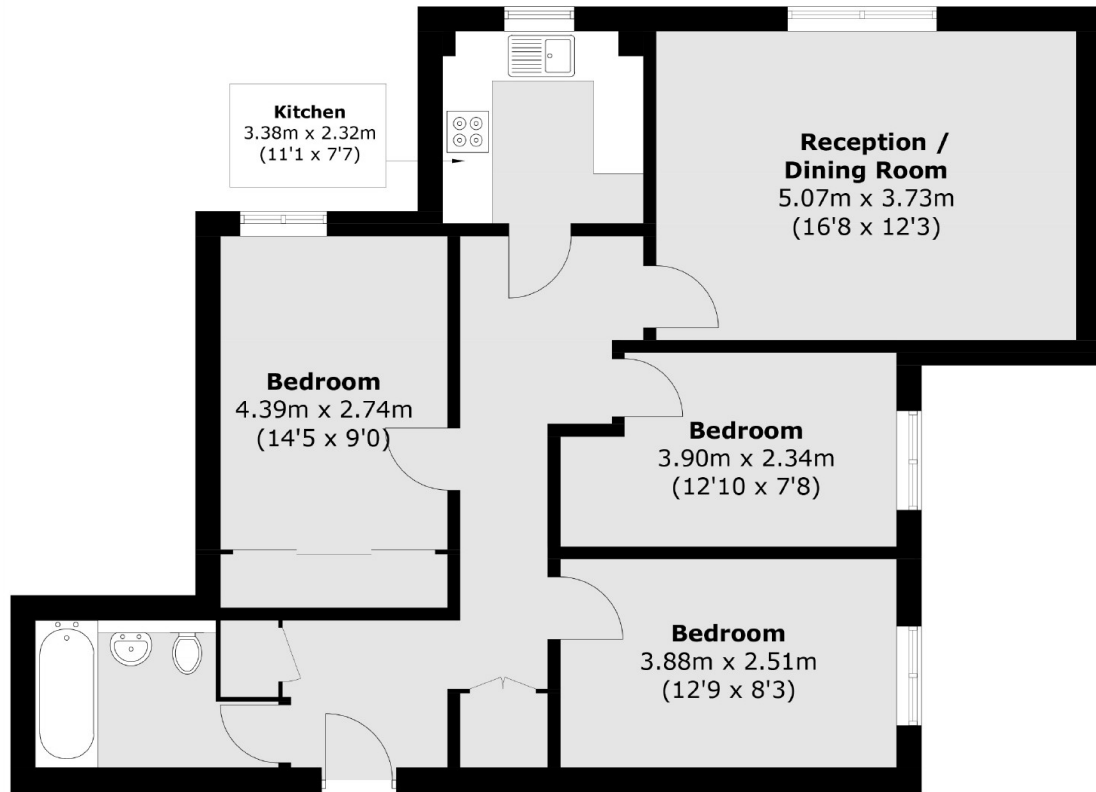

Total area (approx.): 78.0 sq. m (839.6 sq. ft)

## Dexters

Streatham  
105 Streatham Hill  
London  
SW2 4UG  
Sales  
020 8674 7400

Energy Rating: C. We aim to make our particulars both accurate and reliable. However they are not guaranteed; nor do they form part of an offer or contract. If you require clarification on any points then please contact us, especially if you're traveling some distance to view. Please note that appliances and heating systems have not been tested and therefore no warranties can be given as to their good working order.

 **RICS** | Regulated  
Estate Agent  
and Letting Agent

[dexters.co.uk](https://www.dexters.co.uk)