



## Buckleigh Road, SW16

£365,000

Beautifully styled throughout is this one bedroom period conversion, there is a large living space leading through to a stylish kitchen/diner. This bright property leads onto a secluded private terrace which then feeds through to the large communal garden.

The property is located just off Greyhound lane which is equidistant to both Streatham Common and Streatham mainline stations. Streatham High Road is a short walk and offers a vast choice when it comes to cafes, restaurants, bars and the open spaces of Streatham Common

### Features

- Open Plan Living
- Immaculate Condition
- High Ceilings
- Off-Street Parking
- Close to Station
- Quiet Street

# Buckleigh Road, London, SW16

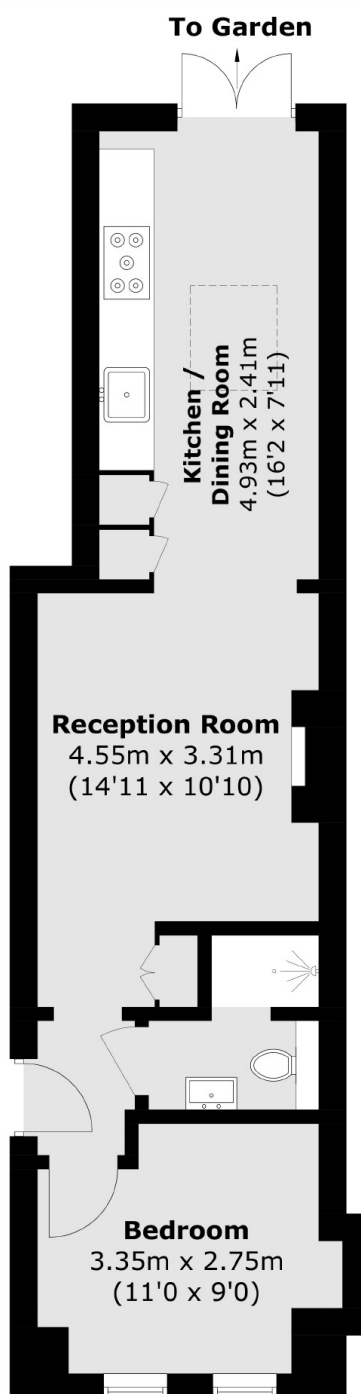

Total area (approx.): 39.2 sq. m (421.9 sq. ft)

## Dexters

Streatham  
105 Streatham Hill  
London  
SW2 4UG  
Sales  
020 8674 7400

Energy Rating: D. We aim to make our particulars both accurate and reliable. However they are not guaranteed; nor do they form part of an offer or contract. If you require clarification on any points then please contact us, especially if you're traveling some distance to view. Please note that appliances and heating systems have not been tested and therefore no warranties can be given as to their good working order.

 **RICS** | Regulated  
Estate Agent  
and Letting Agent

[dexters.co.uk](https://www.dexters.co.uk)