



Ellora Road, SW16

£750,000

Dexters



Ellora Road, SW16

This three double bedroom house is the perfect family home. In great condition throughout, the property has two reception rooms and a large, modern kitchen as well as a downstairs WC. It is being offered to the market chain free.

Upstairs there are three double bedrooms, one of which is currently used as an office, a modern family bathroom and potential to extend into the loft space

Ellora Road is a must see for any family looking for a quality home which is well located to enjoy the benefits of what Streatham has to offer. Streatham and Streatham Common stations provide regular train services into London Bridge and Blackfriars whilst the shops, schools and bus routes are all in close proximity.

Features

- Three Double Bedrooms
- Great Condition
- Close to Station
- Modern Bathroom
- Double Reception
- No Chain



Ellora Road, London, SW16

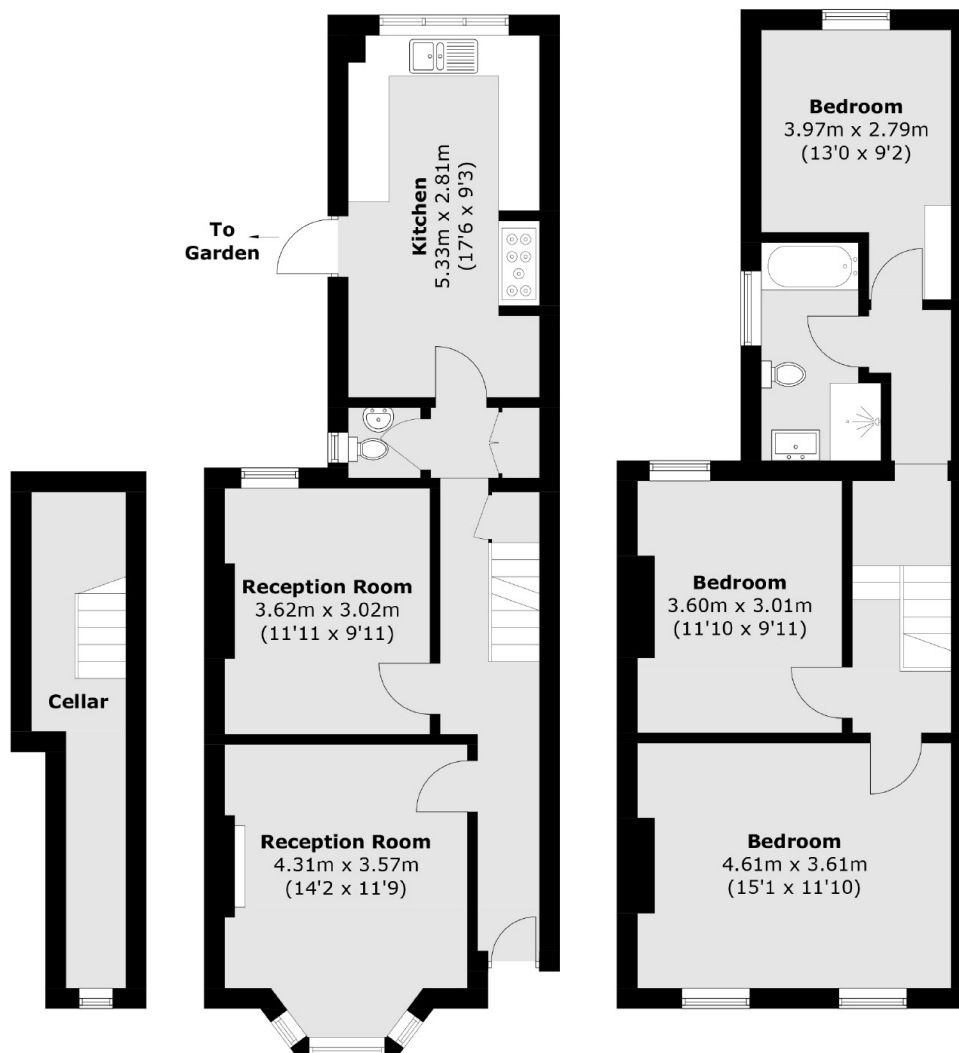

Lower Ground Floor

Ground Floor

First Floor

Total area (approx.): 114.8 sq. m (1,235.7 sq. ft)