

New Barns Avenue, CR4

£2,100 Per calendar month

This three bedroom house has been finished to a good standard throughout. Offering two good size double bedrooms and one smaller bedroom. The property also offers a modern kitchen leading onto a private garden.

Located just minutes away from Mitcham Common, on a sought-after residential road. The property is easy reach of London Victoria (approx 19 minutes) and London Bridge (approx 26 minutes) via Mitcham Eastfield's Station.

Features

- Three Bedroom House
- Two Doubles
- One Single Room
- Private Garden
- Modern Kitchen/ Bathroom
- Wooden Floors

New Barns Avenue,
Mitcham, CR4

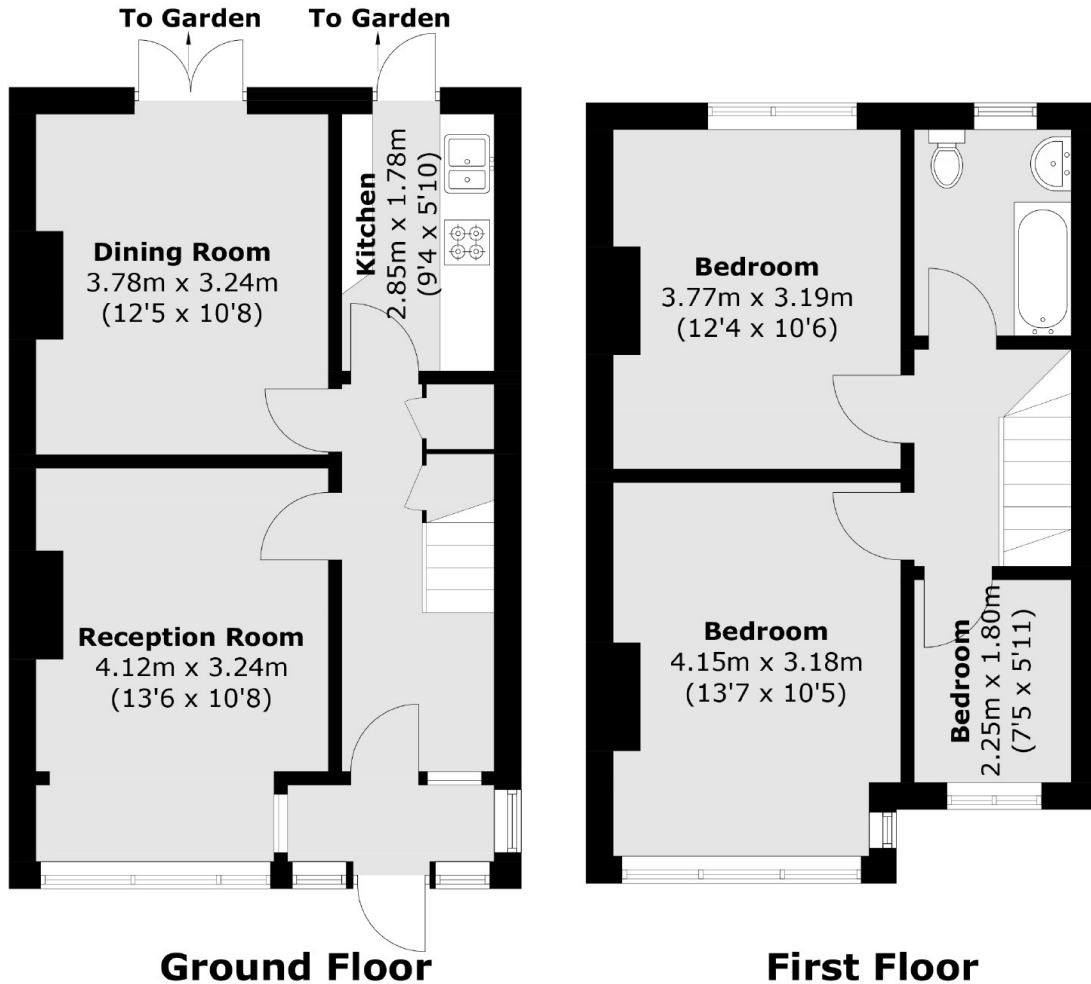

Total area (approx.): 81.7 sq. m (879.4 sq. ft)