



Vincennes Estate, SE27

£375,000

This two double bedroom purpose built property is the perfect first time buy. The property has a large reception room with a separate kitchen and plenty of light throughout. The property benefits from two bathrooms and is being offered chain free.

Hamilton Road is centrally located equidistant between Gipsy Hill and West Norwood stations. Norwood Park open space is nearby, and there is local shopping at the east end of Gipsy Road and in Norwood High Street.

Features

- Two Double Bedrooms
- No Chain
- Separate Kitchen
- Over 690 Sq Ft
- Large Reception Room
- Two Bathrooms

Vincennes Estate, London, SE27

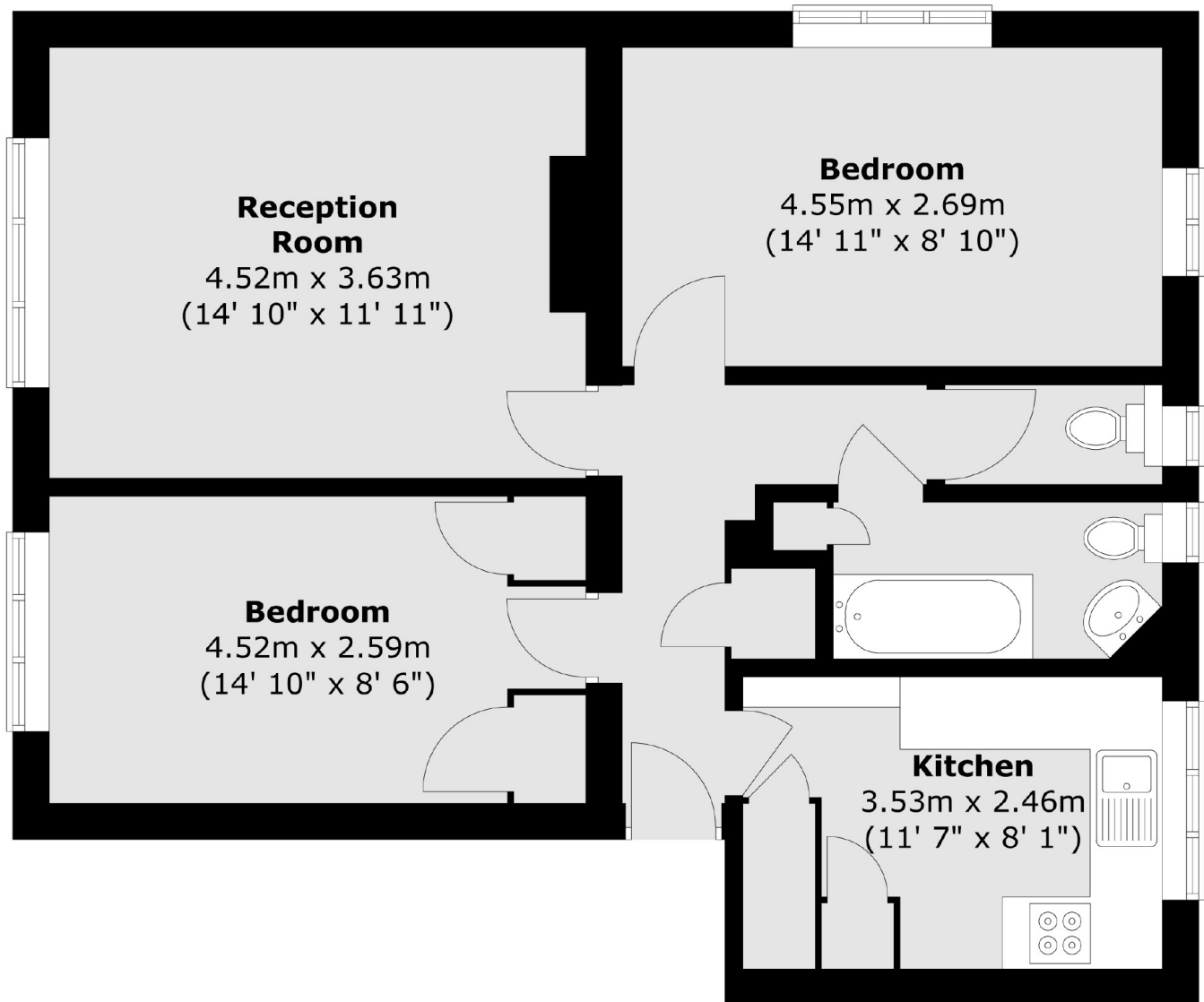

Total area (approx.) : 64.9 sq. m (698 sq. ft)