



## Mountearl Gardens, SW16

£290,000

This modern apartment situated moments from Streatham Hill station is a perfect first time buy. Full of natural light, this home has a double bedroom, open plan living/kitchen as well as benefitting from communal grounds.

Mountearl Gardens is off of Leigham Court Road which offers easy access to Streatham Hill with transport links into Brixton and Clapham Junction. This property is conveniently located for the array of local amenities on Streatham High Road.

### Features

- One Double Bedroom
- Communal Grounds
- Modern Flat
- Open-Plan
- Quiet Location
- Streatham Hill Location

# Mountearl Gardens, London, SW16

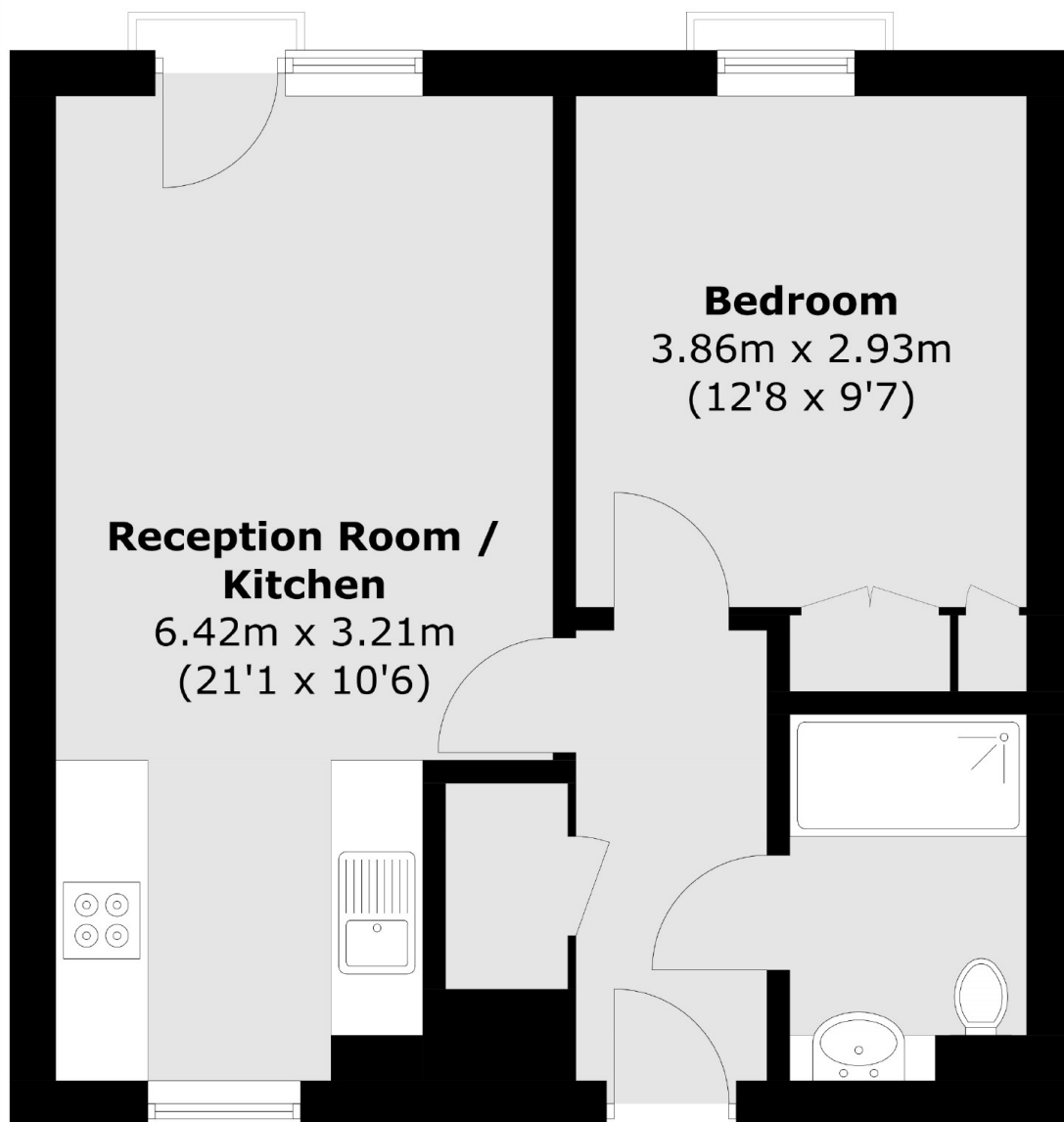

Total area (approx.): 41.2 sq. m (443.5 sq. ft)

**Dexters**

Streatham  
105 Streatham Hill  
London  
SW2 4UG  
Sales  
020 8674 7400

Energy Rating: B. We aim to make our particulars both accurate and reliable. However they are not guaranteed; nor do they form part of an offer or contract. If you require clarification on any points then please contact us, especially if you're traveling some distance to view. Please note that appliances and heating systems have not been tested and therefore no warranties can be given as to their good working order.

 **RICS** | Regulated  
Estate Agent  
and Letting Agent

[dexters.co.uk](http://dexters.co.uk)