



Ellora Road, SW16

£795,000

Dexters



Ellora Road, SW16

Located on a charming residential street is three double bedroom, family home. This property is in great condition throughout and provides a double reception and modern kitchen diner. Bi-fold doors open up onto a low maintenance, paved garden, perfect for summer barbeques.

Upstairs there are three double bedrooms with one currently being used as a study. The current owners have created a stylish family bathroom with four piece suite which services the bedrooms. The basement is ideal for storage and this home has further potential to extend into the loft space.

Ellora Road is a must see for any family looking for a quality home which is well located to enjoy the benefits of what Streatham has to offer. Streatham and Streatham Common stations provide regular train services into London Bridge and Blackfriars whilst the shops, schools and bus routes are all in close proximity.

Features

- Three Double Bedrooms
- Freehold House
- Great Condition
- Close to Station
- Modern Bathroom
- Double Reception



Ellora Road, London, SW16

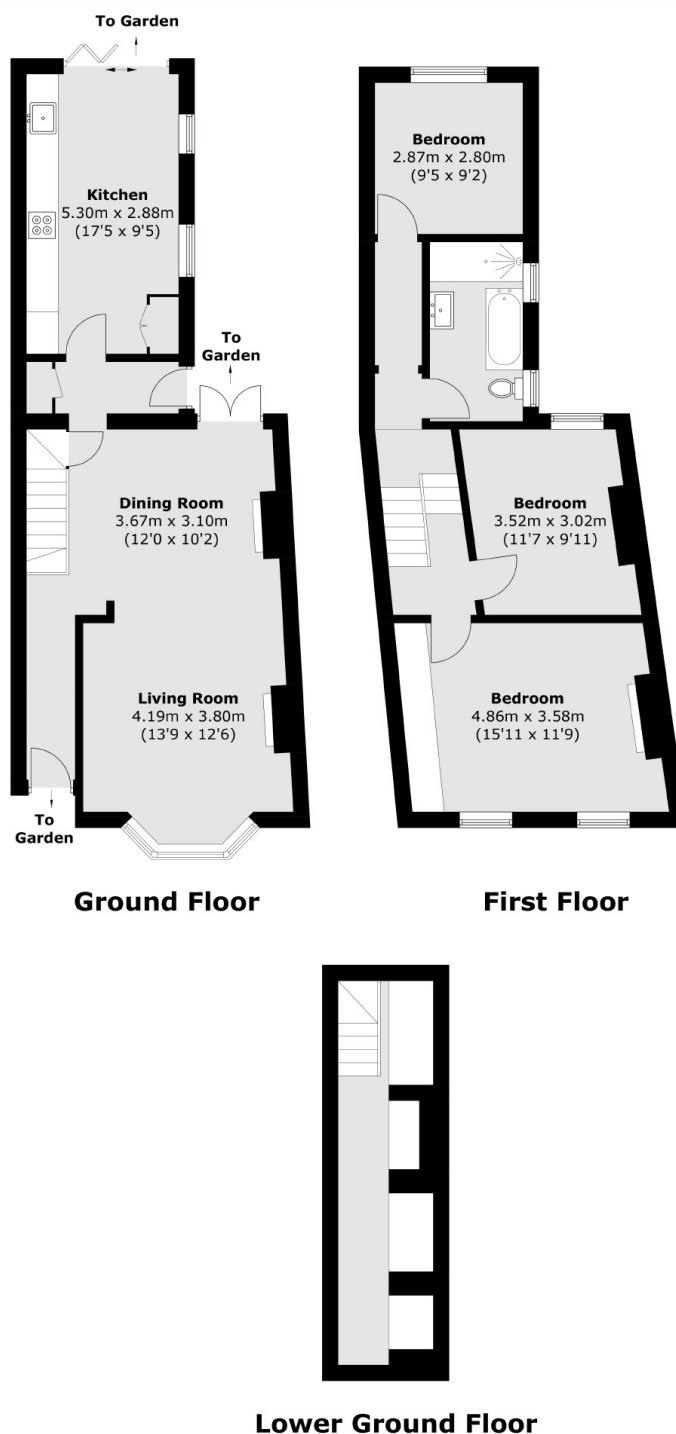

Total area (approx.): 121.3 sq. m (1305.6 sq. ft)