



**Amesbury Avenue, SW2**

**£799,999**

**Dexters**



## Amesbury Avenue, SW2

Spread over three floors is this period, four bedroom family home. Offered with no onward chain is this charming property, with plenty of potential and ample space. This property has a large double reception, kitchen/diner, separate utility and charming courtyard garden.

Upstairs there are four bedrooms spread over two floors, the first floor has a large primary bedroom to the front with two further double rooms, serviced by a family bathroom and separate w/c. On the top floor is a large bedroom which houses a shower, separate toilet and small kitchenette, ideal for a Au Pair or lodger.

Amesbury Avenue is conveniently located within easy reach of Streatham Hill mainline offering rail links to London Victoria (via Clapham Junction) and London Bridge. Streatham High road also offers a range of shops and restaurants.

### Features

- Four Bedrooms
- Chain Free
- Double Reception
- Separate Utility
- Period Property
- Close to Station



# Amesbury Avenue, London, SW2

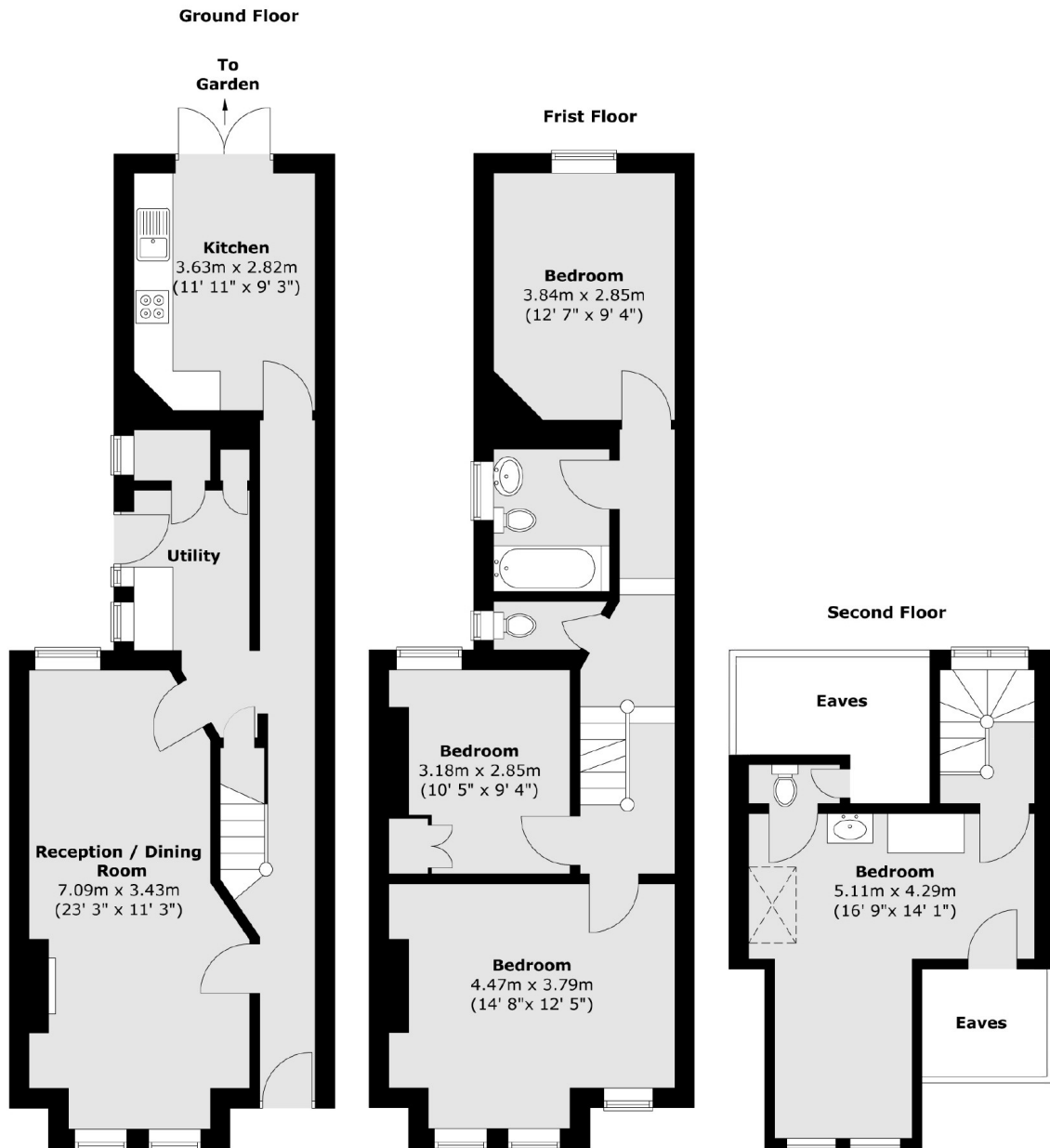

Total area (approx.) : 125.1 sq. m (1347 sq. ft)  
(Excluding Eaves)