



Lanercost Road, SW2

£1,595,000

Dexters



Lanercost Road, SW2

At over 2,000sqft is this charming, four double bedroom family home. Upon entry you are met with a large hallway, that all three reception rooms and kitchen diner lead off. The double reception can be separated off with tall double doors, or opened up for entertaining, they house two stunning period fireplaces and provide access to the private garden.

The kitchen/diner is flooded with natural light and can hold an 8-10 seater dining table; continuing through the room you will enter the mature private garden with back bricked wall. Upstairs there are four double bedrooms with one containing an en-suite. The family bathroom is modern and contains both a bath and freestanding shower.

This property is a beautiful family home and has the added benefit of a downstairs utility, off-street parking and being offered with no onward chain.

Lanercost Road is one of the prettiest tree-lined streets in Tulse Hill. Tulse Hill offers links to London Bridge and Blackfriars via the Thameslink service. Brockwell park is nearby for recreation and West Norwood High Street offers a range of shops, restaurants and local amenities.

Features

- Four Double Bedrooms
- Chain Free
- Three Reception Rooms
- Off-Street Parking
- Over 2,000sqft
- Close to Station







Lanercost Road, London, SW2

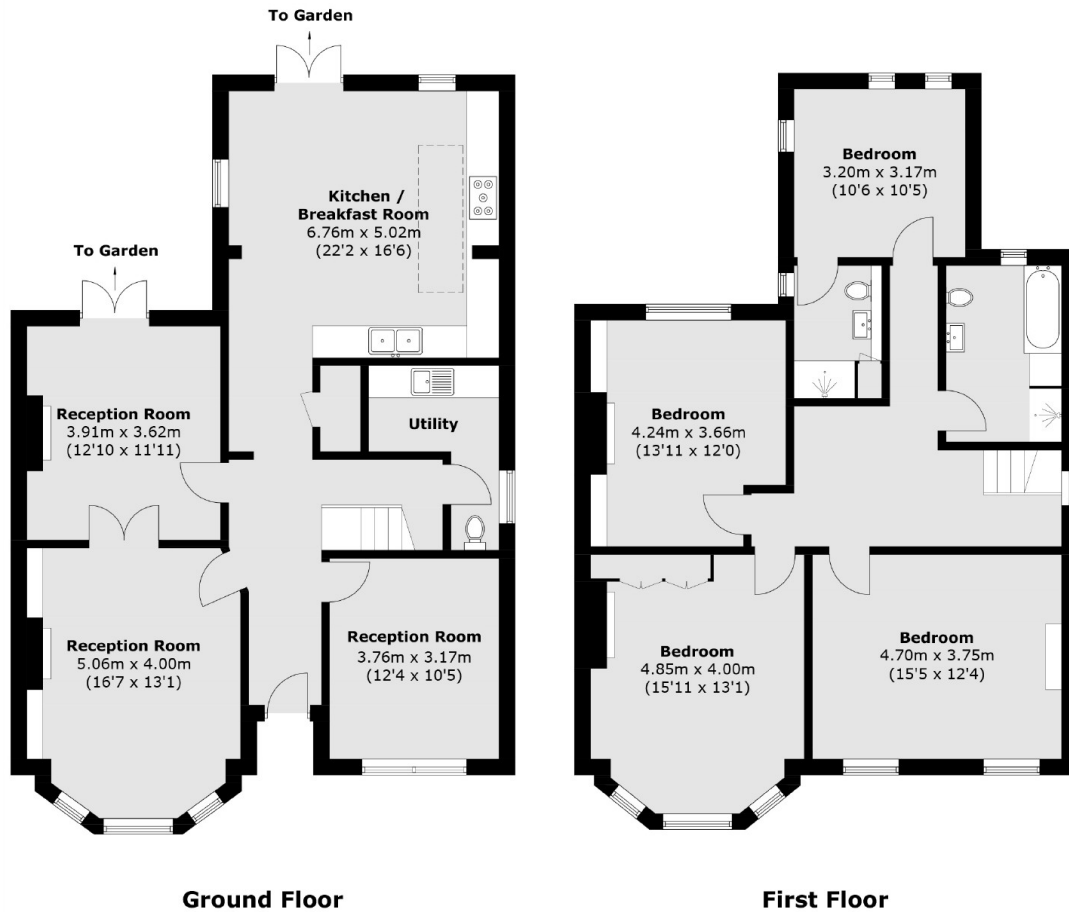

Total area (approx.): 186.7 sq. m (2,009.6 sq. ft)