

Wyatt Park Road, SW2

£625,000

Offered with no onward chain is this newly renovated, two double bedroom, period conversion. At just under 800qft, this property has two bathrooms, with one being en-suite as well as a large open-plan living space.

Leading through the bi-fold doors you are met with an incredible garden which has both a paved and turfed area, ideal with the summer evenings. This property is also being sold with a newly extended lease.

Wyatt Park Road is just off Streatham High Road, offering a range of shops and local amenities. Streatham Hill Station is a short walk away offering links to London Victoria via Clapham Junction. Alternatively Tulse Hill station can also be used providing links into the city via the Thameslink service.

Features

- Newly Refurbished
- Two Double Bedrooms
- Large Garden
- Open-Plan Living
- Stylishly designed
- Great Location

Wyatt Park Road, London, SW2

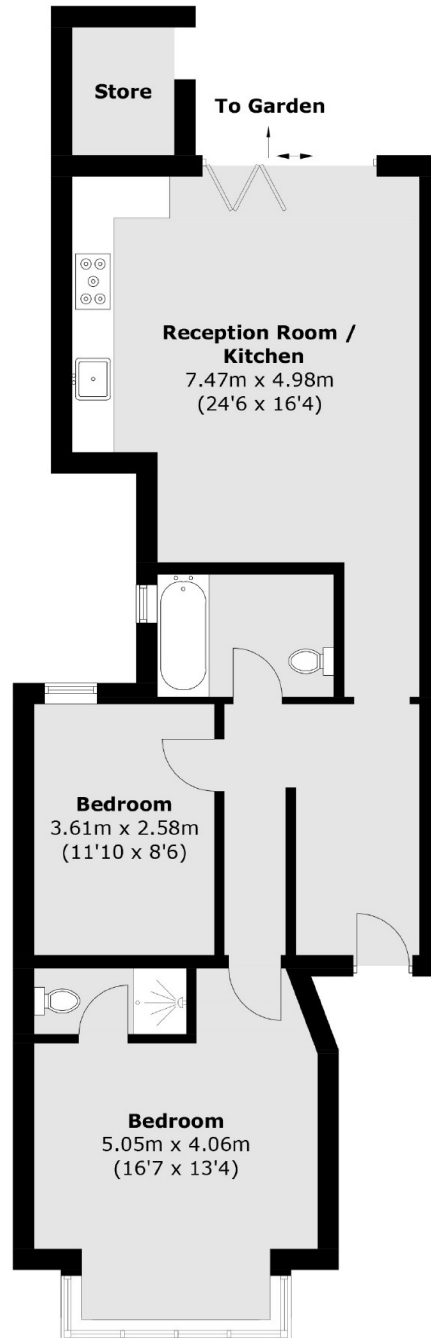

Total area (approx.): 73.2 sq. m (787.9 sq. ft)
Store: 2.7 sq. m (29.1 sq. ft)