



Wyatt Park Road, SW2
£550,000

Dexters



Wyatt Park Road, SW2

With two spacious double bedrooms, this charming period property has plenty of potential but is ready to move straight in. There is a separate kitchen with reception room attached as well as a large, mature private garden. This property is sold with no onward chain and with a share in the freehold.

The south facing garden can be accessed via the rear of the property or through the side access, ideal for maintenance. This home is full of period features and located on an attractive residential street.

Wyatt Park Road is just off Streatham High Road, offering a range of shops and local amenities. Streatham Hill Station is a short walk away offering links to London Victoria via Clapham Junction. Tulse Hill Station can be easily accessed also and forms part of the Thameslink service into Blackfriars and London Bridge.

Features

- Two Double Bedrooms
- Large Private Garden
- Chain Free
- Period Features
- Share of Freehold
- Separate Kitchen



Wyatt Park Road,
London, SW2

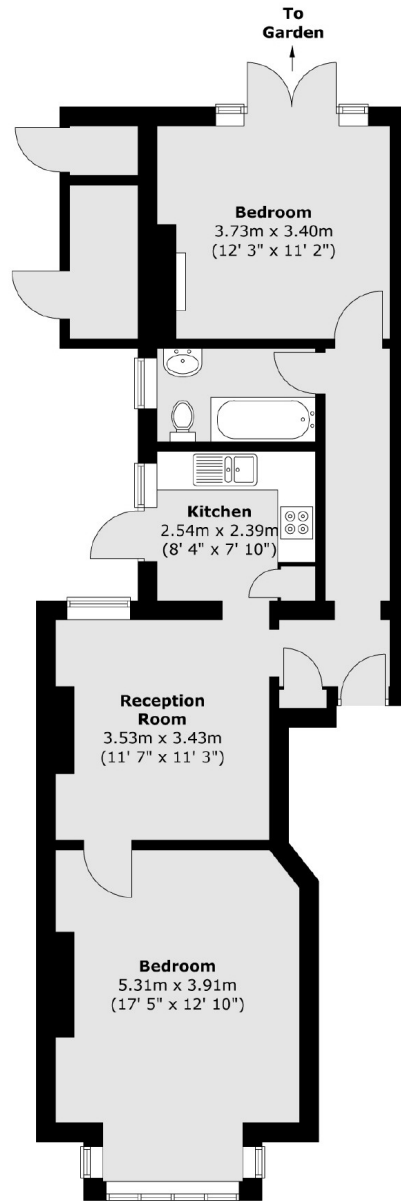

Total area (approx.) : 64.2 sq. m (691 sq. ft)
Total store area (approx.) : 3.7 sq. m (40 sq. ft)