



## Knollys Road, SW16

### £250,000

A unique ground floor studio apartment with private entrance and direct access to well kept communal gardens. Similar in size to many one bedroom flats and with a separate sleeping area and modern kitchen it provides the ideal step onto the property ladder.

Knollys Road is situated within easy reach of Streatham High Road, with a superb selection of shops, bars and restaurants. Mainline rail links include both Streatham Hill and Tulse Hill stations and local bus routes to Brixton and surrounding areas.

### Features

- Ground Floor
- Studio Apartment
- Separate Sleeping Area
- Communal Gardens
- Sought After Road
- No onward chain

# Knollys Road, London, SW16

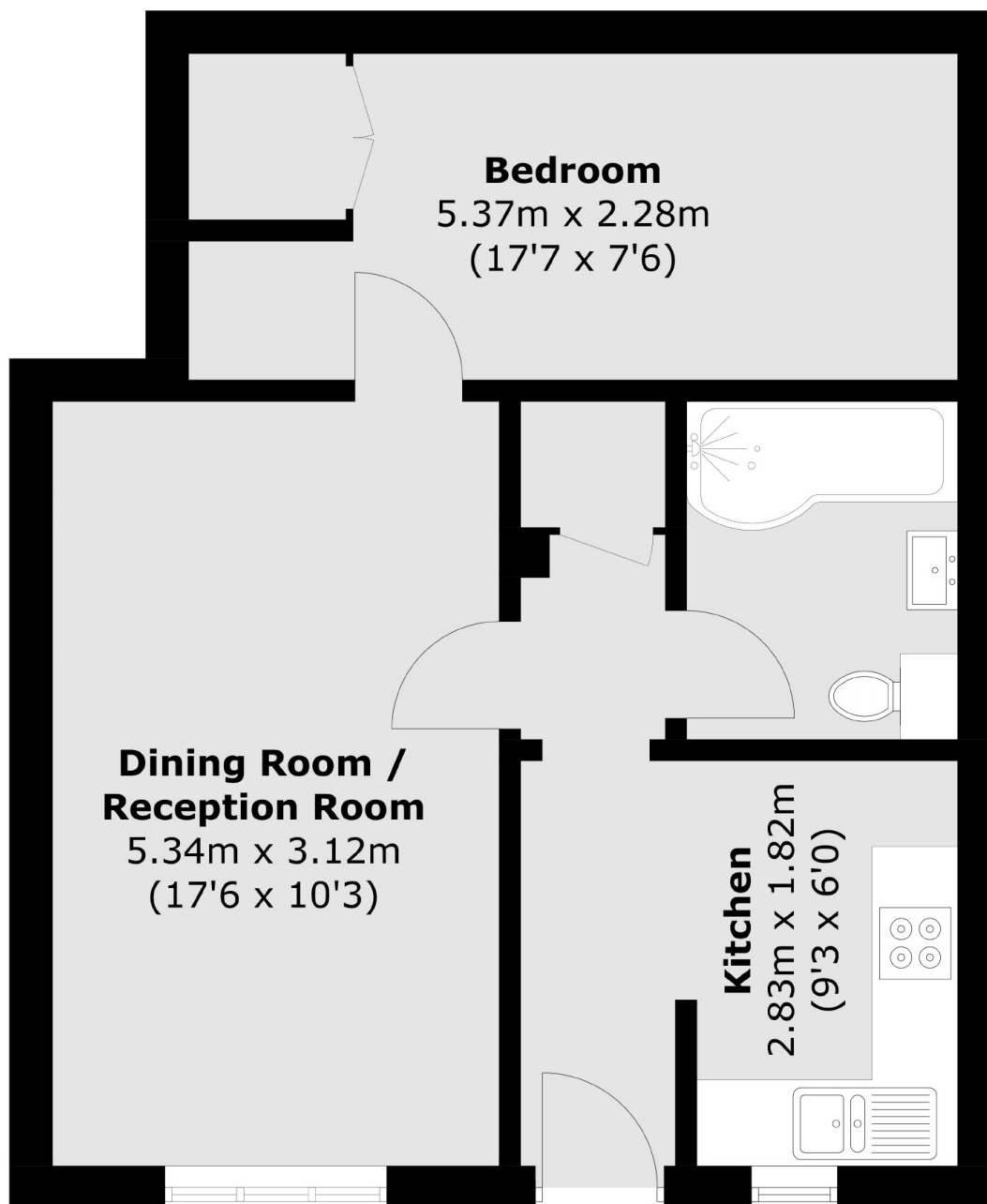

Total area (approx.): 46.9 sq. m (504.8 sq. ft)