



## Christchurch Road, SW2

£450,000

This delightful and well-presented two double bedroom apartment is larger than average and a must-see for any first time buyer. The property benefits from a stylish kitchen, modern bathroom and is sold with the added benefit of a garage, generous storage unit and a share of freehold. This property is also sold with no onward chain.

Linden Court is conveniently situated within easy reach of Tulse Hill station for rail links to several London mainline stations, and frequent buses to Brixton. The shops, bars and restaurants of Streatham Hill and Norwood Road are also just a short walk away.

### Features

- First Floor
- Excellent Decorative Order
- Two Double Bedrooms
- Bright Reception
- Modern Kitchen and Bathroom
- Private Garage

Christchurch Road,  
London, SW2

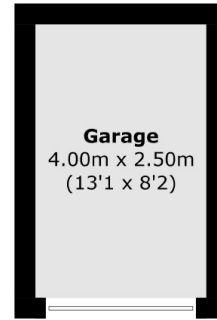

(Not Shown In Actual  
Location / Orientation)

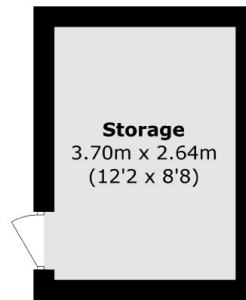
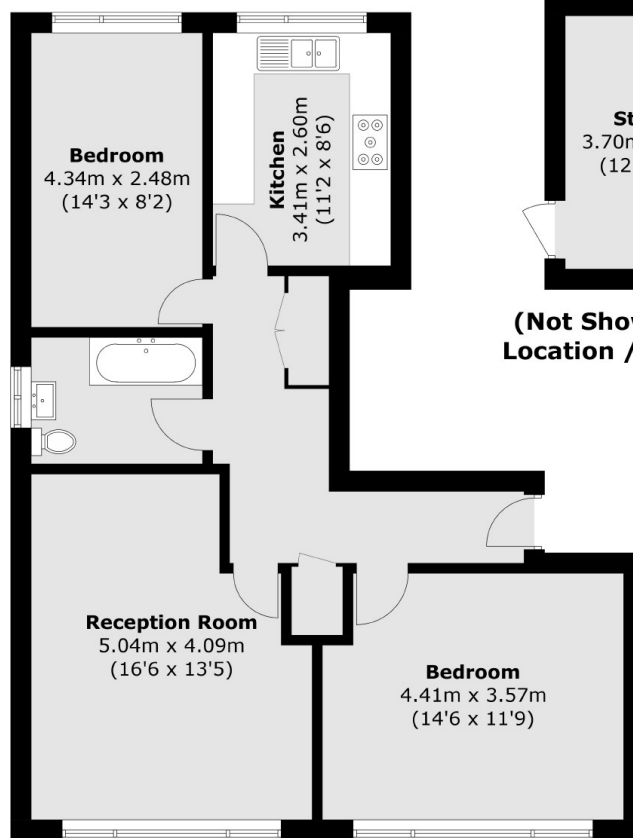

(Not Shown In Actual  
Location / Orientation)

Total area (approx.): 72.1 sq. m (776.1 sq. ft)  
Outbuildings: 19.9 sq. m (214.2 sq. ft)