



## Mountearl Gardens, SW16

£325,000

A top floor two bedroom flat decorated neutrally throughout with a large reception and separate kitchen. This property is perfect for any buyer looking for their step onto the ladder.

Mountearl Gardens is off of Leigham Court Road which offers easy access to Streatham Hill with transport links into Brixton and Clapham Junction.

### Features

Two Bedroom Flat  
Balcony  
Separate Kitchen  
Good Size Lounge  
Chain Free  
Neutrally Decorated

# Mountearl Gardens, London, SW16

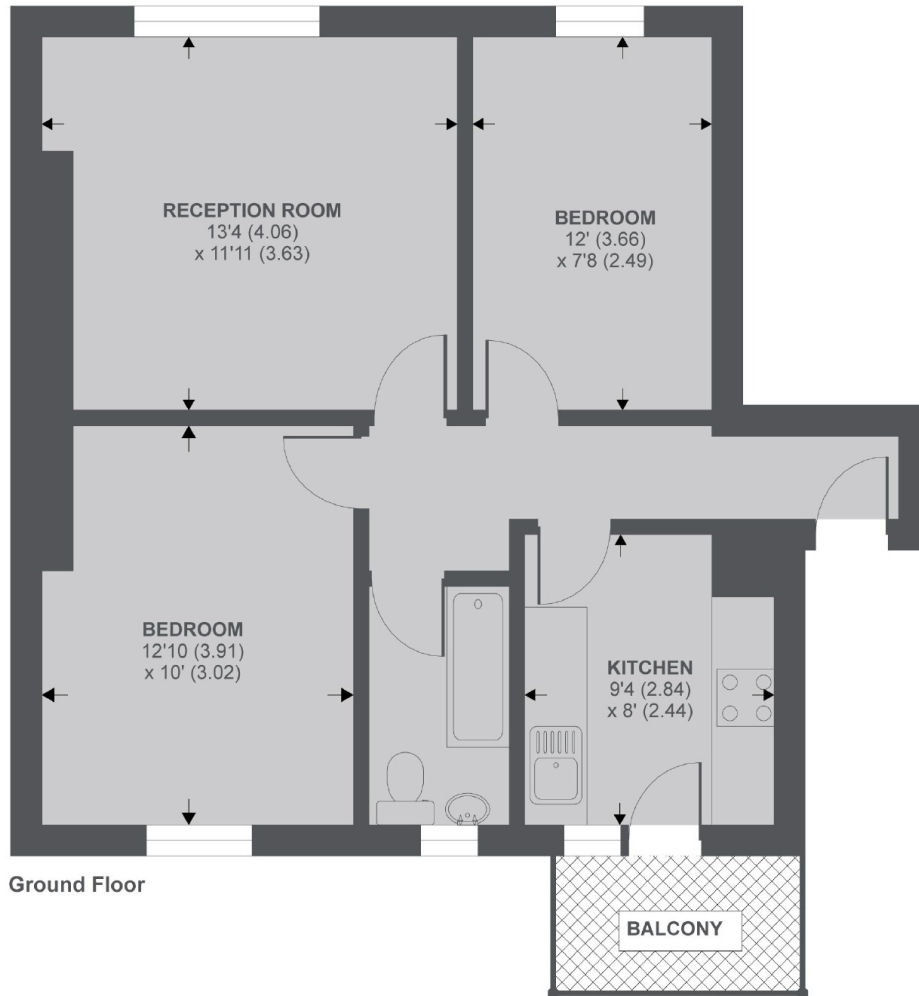

APPROX FLOOR AREA 580 SQ.FT 53.8 SQ.M

Copyright nichecom.co.uk 2019 REF : 563371

## Dexters

Streatham  
105 Streatham Hill  
London  
SW2 4UG  
Sales  
020 8674 7400

Energy Rating: D. We aim to make our particulars both accurate and reliable. However they are not guaranteed; nor do they form part of an offer or contract. If you require clarification on any points then please contact us, especially if you're traveling some distance to view. Please note that appliances and heating systems have not been tested and therefore no warranties can be given as to their good working order.

 **RICS** | Regulated  
Estate Agent  
and Letting Agent

dexters.co.uk