



Mountearl Gardens, SW16

£340,000

A top floor two bedroom flat decorated neutrally throughout with a large reception and separate kitchen. This property is perfect for any buyer looking for their step onto the ladder.

Mountearl Gardens is off of Leigham Court Road which offers easy access to Streatham Hill with transport links into Brixton and Clapham Junction.

Features

Two Bedroom Flat
Balcony
Separate Kitchen
Good Size Lounge
Chain Free
Neutrally Decorated

Mountearl Gardens, London, SW16

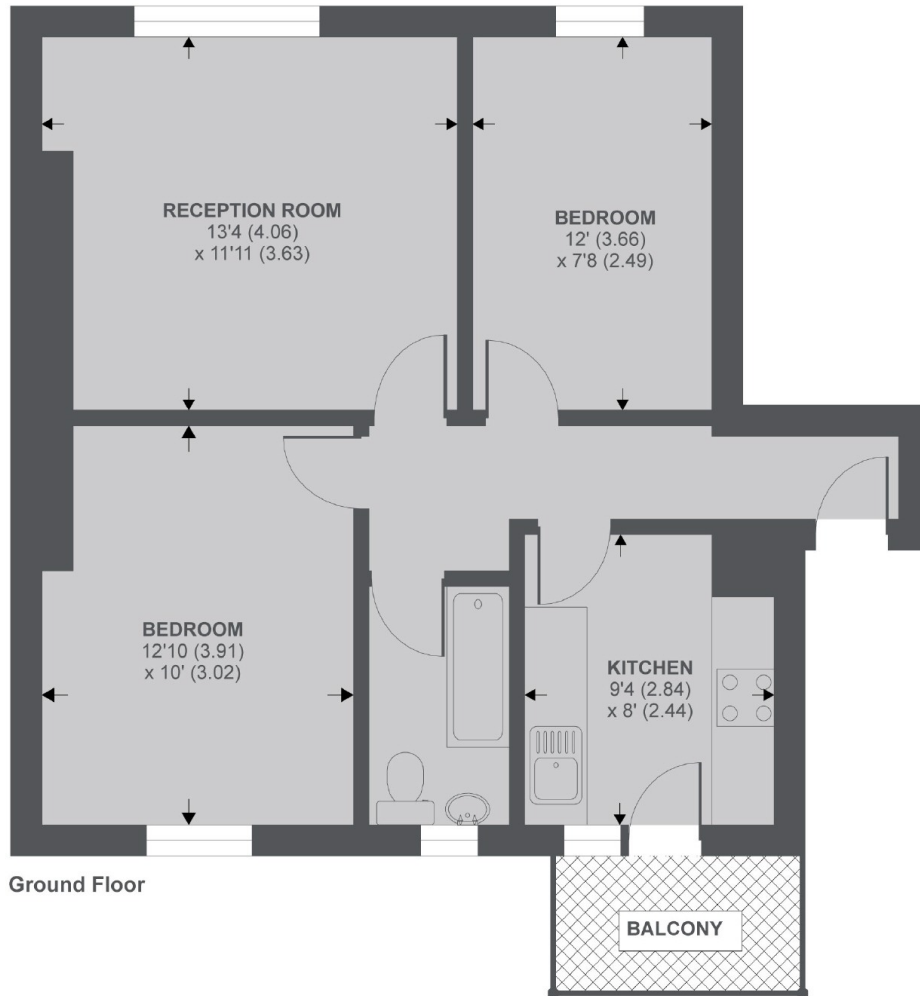

Ground Floor

APPROX FLOOR AREA 580 SQ.FT 53.8 SQ.M

Copyright nichecom.co.uk 2019 REF : 563371

Dexters

Streatham
105 Streatham Hill
London
SW2 4UG
Sales
020 8674 7400

Energy Rating: D. We aim to make our particulars both accurate and reliable. However they are not guaranteed; nor do they form part of an offer or contract. If you require clarification on any points then please contact us, especially if you're traveling some distance to view. Please note that appliances and heating systems have not been tested and therefore no warranties can be given as to their good working order.

 **RICS** | Regulated
Estate Agent
and Letting Agent

dexters.co.uk