



## Streatham Road, CR4

£350,000

This first floor conversion property, has two bedrooms with open plan kitchen and living room. Recently refurbished to a high standard, this modern flat benefits from a private balcony.

Located on the borders of Tooting, Streatham and Mitcham the property is equidistant to Tooting and Mitcham Eastfields mainline stations and a vast selection of buses also close by.

### Features

- Two Bedroom
- Recently Refurbished
- Private Balcony
- Share of Freehold
- Period Conversion
- 700 Square Feet

Streatham Road,  
Mitcham, CR4

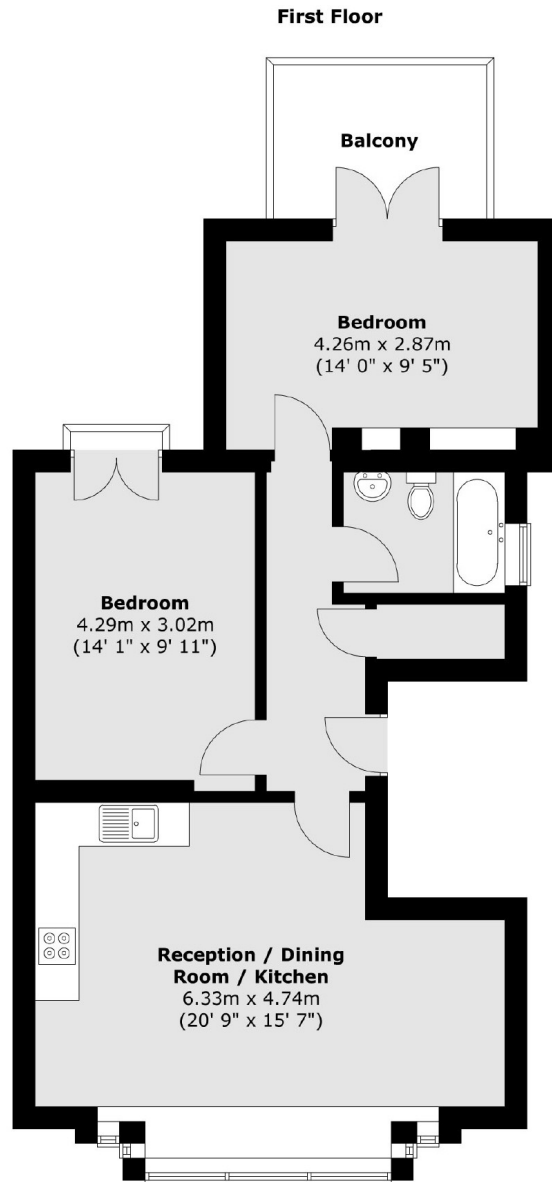

Total area (approx.) : 65.2 sq. m (702 sq. ft)  
Total balcony area (approx.) : 6.1 sq. m (66 sq. ft)