



## Conyers Road, SW16 £600,000

A huge lateral apartment measuring just under 900 square feet in total. There is two bedrooms, two bathrooms and built in storage. To the rear you have a private patio which leads to a large communal garden. All for sale with no onward chain.

Conyers Road is just a short walk from Streatham station and the town centre with trains providing Southern and Thames link services with direct access into London. The green open spaces of Streatham Common are also nearby.

### Features

Two Bedrooms Two  
Bathrooms  
Private Patio  
Communal Gardens  
Near To Streatham Common  
No Chain  
Just Under 900 Square Feet

Conyers Road,  
, SW16

 = Reduced headroom below 1.5m / 5'0

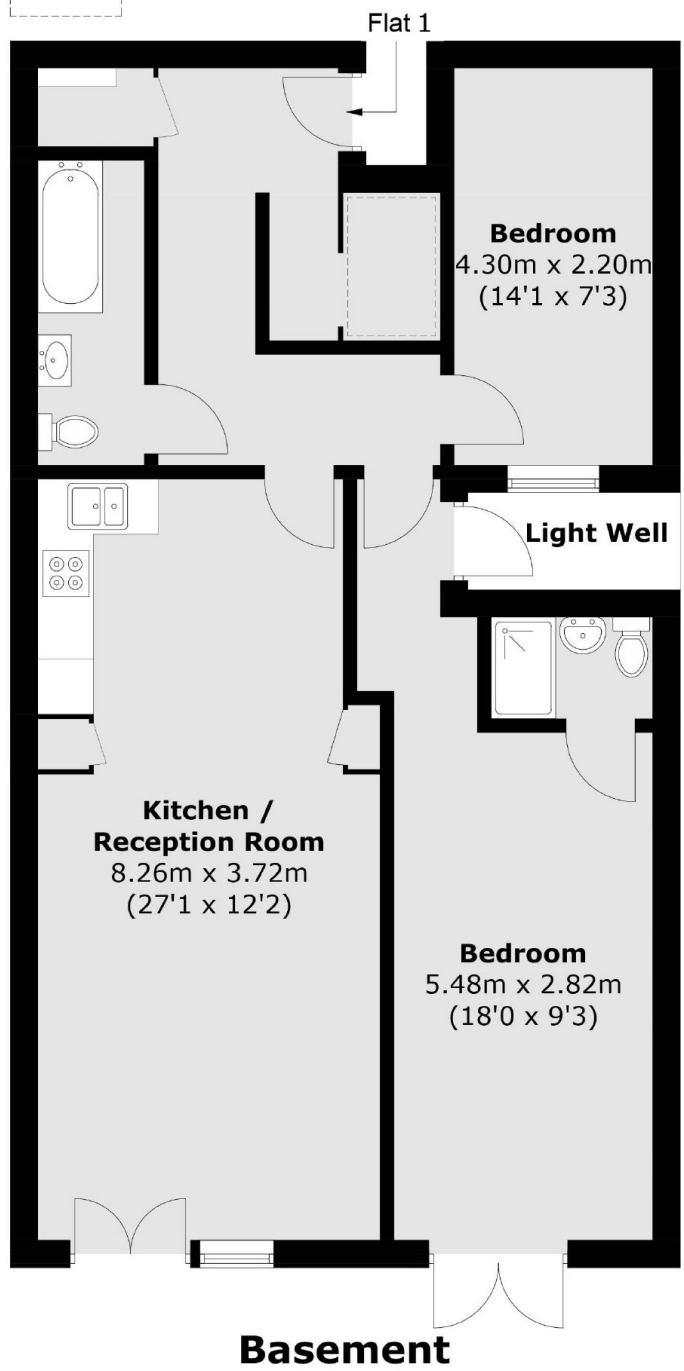

Total area (approx.): 83.2 sq. m (895.6 sq. ft)