



**Chase**Buchanan



# Osterley Road, Isleworth

## £925,000

- Viewings accompanied by Chase Buchanan
- Arts & Crafts semi-detached family home
- Four bedrooms
- Two reception rooms
- Two bathrooms
- Double garage

An immaculately presented semi-detached Arts & Crafts style home located on the highly coveted Osterley Road.

The ground floor accommodation comprises an inviting hallway, a bright reception room, a dining room, a kitchen open plan to the conservatory and a shower room. The first floor offers three generous sized bedrooms and a family bathroom whilst the second floor boasts a fourth bedroom and eaves storage. Externally there is a front garden, mature rear garden and a double garage which is accessed through Caroline Close.

Osterley Road is a desirable tree lined road which is ideally situated for Isleworth mainline station and Osterley underground station (Piccadilly line), with Osterley Park and some highly regarded schools in the immediate vicinity.



# Osterley Road TW7

Approx. Gross Internal Floor Area  
186.1 Sq M - 2004 Sq Ft



Ground Floor  
Approximate Floor Area  
804.25 sq.ft  
(74.71 sq.m)



First Floor  
Approximate Floor Area  
665.30 sq.ft  
(61.80 sq.m)

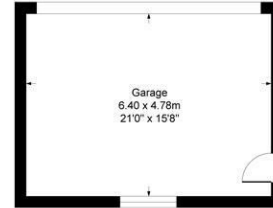

Garage  
Approximate Floor Area  
328.30 sq.ft  
(30.5 sq.m)

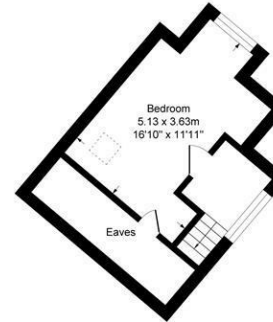

Second Floor  
Approximate Floor Area  
206.649 sq.ft  
(19.19 sq.m)







