

**Thornbury Road
Isleworth
TW7 4LN**

£1,700 Per Month

ChaseBuchanan

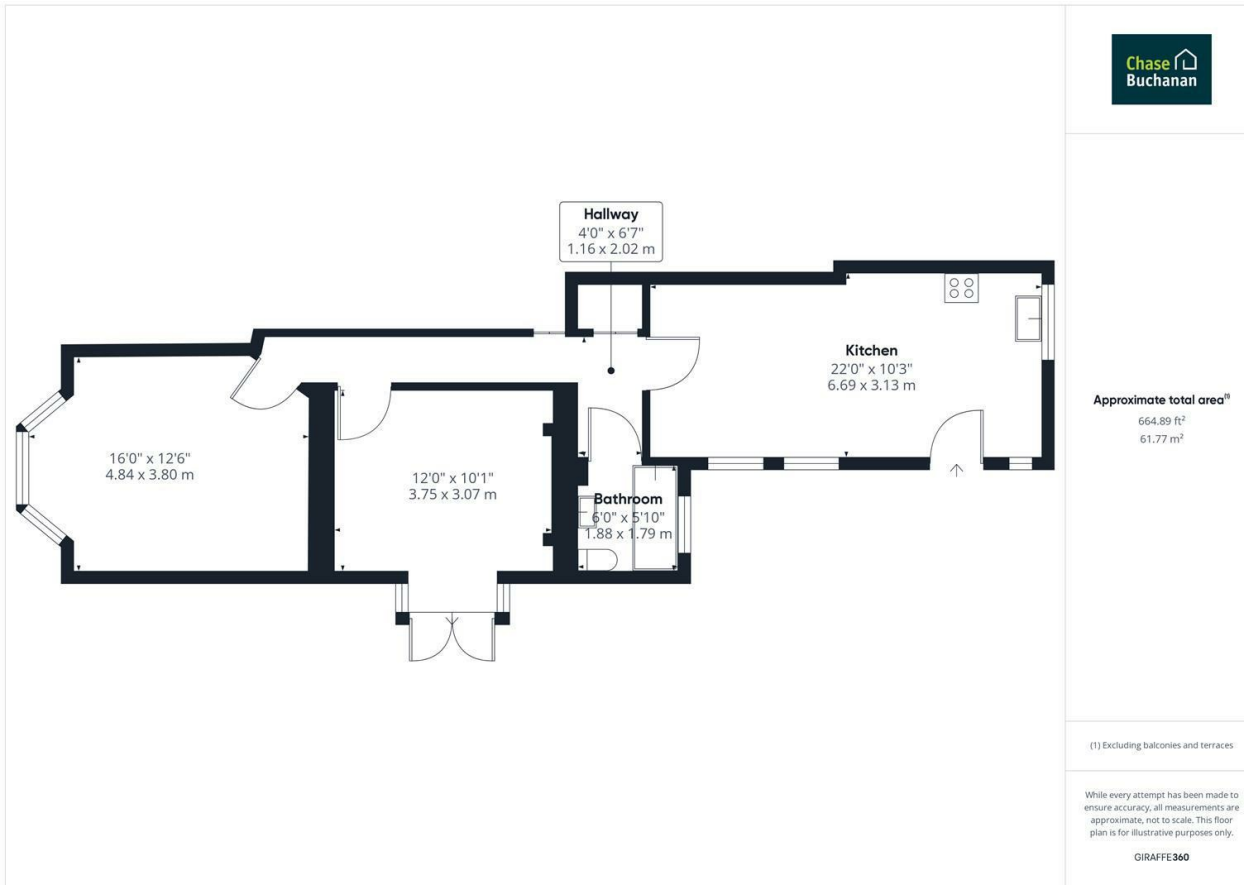



- Viewings Accompanied by Chase
- Desired Location Buchanan
- Spacious Bedroom and Lounge
- Garden Flat
- Fully Equipped Kitchen
- Private Parking
- Osterley Tube & Isleworth Station
- EPC C
- Nearby

Introducing a stunning ground floor Edwardian conversion located on Thornbury Road in Isleworth, near Osterley. This elegant property features spacious double bedrooms with fitted wardrobes, high-ceilings, open plan kitchen and lounge, and the option to use the reception area as a second bedroom. Additional amenities include an allocated parking space and access to a communal garden. Conveniently situated near Isleworth Train Station and Osterley Tube Station, this home offers both charm and practicality.

For more information or to book a viewing, please contact:

020 8758 1755

ChaseBuchanan

7 Odeon Parade, 480 London Road, Isleworth, Middlesex, TW7 4DE

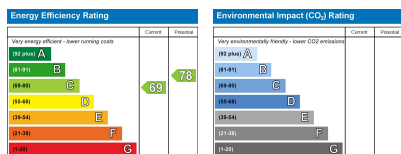

Care has been taken in the preparation of these particulars, however, their accuracy is not guaranteed and they do not form part of any contract. Measurements stated must be considered maximum.