



**Thornbury Road  
Isleworth**

£400,000

**ChaseBuchanan**



## Key Features

- Viewings accompanied by Chase Buchanan
- Ground floor maisonette
- Two double bedrooms
- Modern kitchen
- Garage
- Share of freehold
- Well located for Osterley tube & Isleworth mainline station
- Chain free

## Description

A fantastic ground-floor maisonette, located in this quiet development off Thornbury Road.

The accommodation comprises a bright, spacious reception room, a modern kitchen, two double bedrooms, and a bathroom. Further benefits include share of freehold, a garage, ample storage, and beautiful communal gardens.

This property is well situated for all the local shops, amenities, and transport links of both Isleworth and Osterley. Osterley tube station is within easy walking distance, as is Isleworth BR mainline station with its direct links to Waterloo.







# The Fairways TW7

Approx. Gross Internal Floor Area  
80.2 Sq M - 864 Sq Ft

ChaseBuchanan

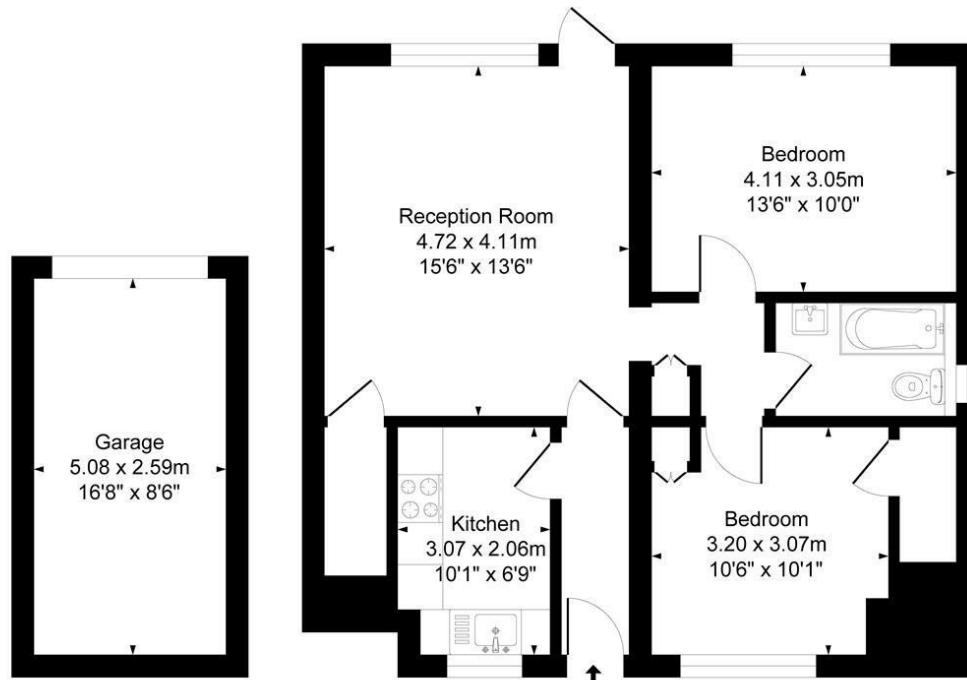

Garage  
Approximate Floor Area  
141.66 sq.ft  
(13.16 sq.m)

Ground Floor  
Approximate Floor Area  
721.83 sq.ft  
(67.06 sq.m)

Illustration for identification purposes only, measurements are approximate, not to scale.  
Produced By Esjay Property Marketing

Care has been taken in the preparation of these particulars, however, their accuracy is not guaranteed and they do not form part of any contract. Measurements stated must be considered maximum.

Energy Efficiency Rating		Current	Proposed	Environmental Impact (CO <sub>2</sub> ) Rating		Current	Proposed
Very energy efficient - lower running costs				Very environmentally friendly - lower CO <sub>2</sub> emissions			
(92 plus) A				(92 plus) A			
(81-91) B				(81-91) B			
(69-80) C				(69-80) C			
(55-68) D				(55-68) D			
(39-54) E				(39-54) E			
(21-38) F				(21-38) F			
(1-20) G				(1-20) G			
Not energy efficient - higher running costs				Not environmentally friendly - higher CO <sub>2</sub> emissions			
EU Directive 2002/91/EC				EU Directive 2002/91/EC			
England & Wales				England & Wales			

For more information or to book a viewing, please contact:

**020 8758 1755**

isleworth@chasebuchanan.london

480 London Road, TW7 4DE

**ChaseBuchanan**