

**Worton Road  
Isleworth  
TW7 6HG**

£1,600 PCM

**ChaseBuchanan**

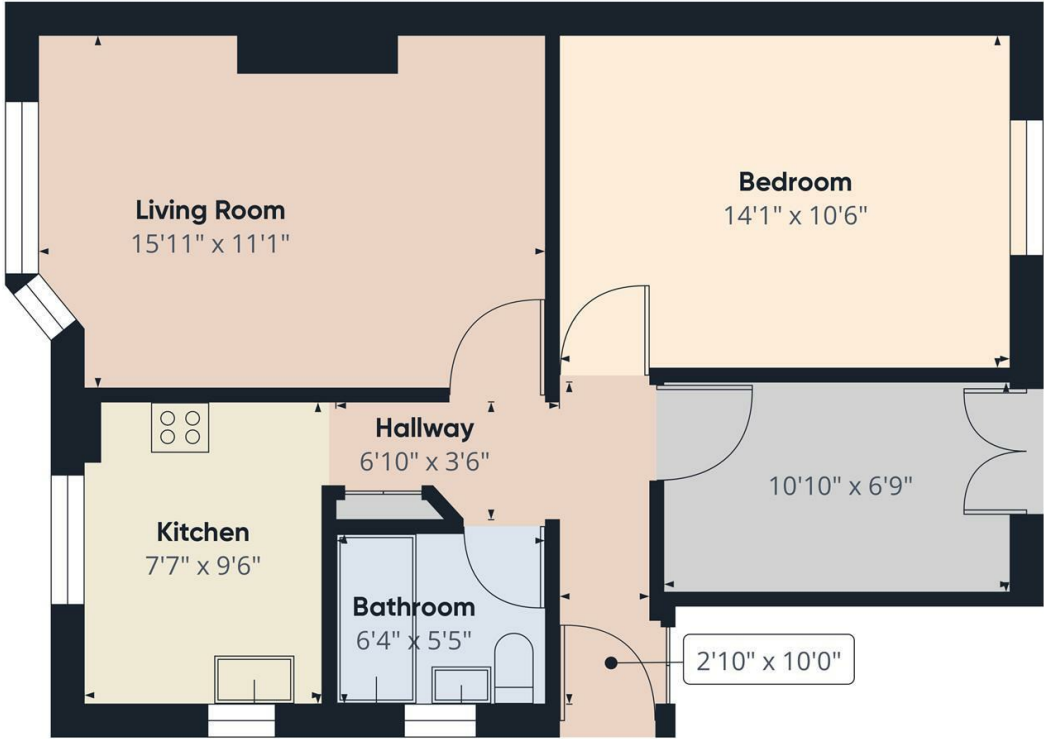



Approximate total area<sup>(1)</sup>  
567.54 ft<sup>2</sup>

(1) Excluding balconies and terraces

While every attempt has been made to ensure accuracy, all measurements are approximate, not to scale. This floor plan is for illustrative purposes only.

GIRAFFE360

- Viewings Accompanied by Chase Buchanan
- Double Bedrooms
- Maisonette
- Spacious Lounge
- Patio and Garden Access
- Nearby to Tube and Overground Stations
- Gas Central Heating
- EPC D

This well-presented, spacious two double bedroom maisonette on Worton Road, Isleworth, is conveniently located near local amenities, Isleworth Main Line Station, Hounslow High Street, Hounslow Bus Station, and Hounslow East Tube. This property boasts two generously sized bedrooms, modern family bathroom and modern fitted kitchen with appliances. The spacious family lounge offers a fireplace with original pine wood flooring. There is also ample storage, as well as access to a rear patio and garden. This maisonette offers both comfort and convenience in a desirable location.

Viewings are highly recommended!

For more information or to book a viewing, please contact:

020 8758 1755

**Chase**Buchanan

7 Odeon Parade, 480 London Road, Isleworth, Middlesex, TW7 4DE

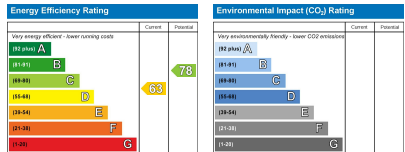

Care has been taken in the preparation of these particulars, however, their accuracy is not guaranteed and they do not form part of any contract. Measurements stated must be considered maximum.