



**Great West Road
Osterley**

£450,000

ChaseBuchanan

Key Features

- Viewings accompanied by Chase Buchanan
- Three double bedrooms
- Residents parking
- Moments from Osterley tube station
- Long lease
- Immaculately maintained communal grounds
- Spacious accommodation
- No onward chain



Description

This superb three double-bedroom apartment comprises a spacious lounge with a bay-fronted window, a kitchen/breakfast room, and a bathroom. One bedroom is currently being shown as a dining room option. Further benefits include character features throughout, residents parking, ample storage, a long lease, and immaculately maintained communal grounds. The property is sold as chain-free.

Penwerris Court is well located next to Osterley tube station (Piccadilly line) and the A4 with direct road links in and out of central London. The open spaces of Osterley Park are also close by. An early viewing is highly recommended to avoid disappointment through the vendor's sole agent Chase Buchanan.





Penwerris Court TW5

Approx. Gross Internal Floor Area
84.3 Sq M - 908 Sq Ft

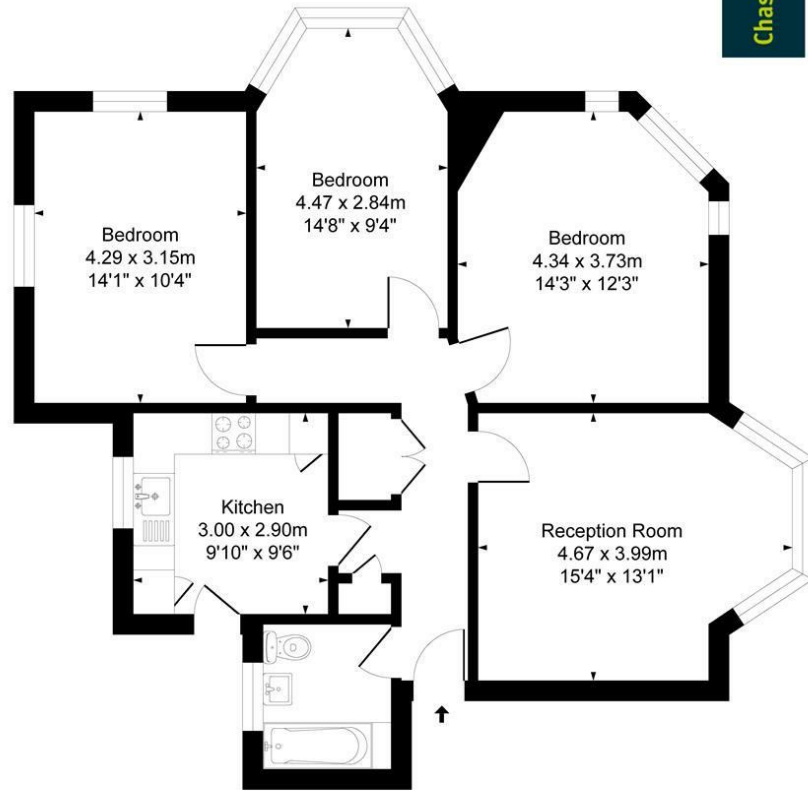

Top Floor

Illustration for identification purposes only, measurements are approximate, not to scale.
Produced By Esjay Property Marketing

For more information or to book a viewing, please contact:

020 8758 1755

isleworth@chasebuchanan.london

480 London Road, TW7 4DE

Care has been taken in the preparation of these particulars, however, their accuracy is not guaranteed and they do not form part of any contract. Measurements stated must be considered maximum.

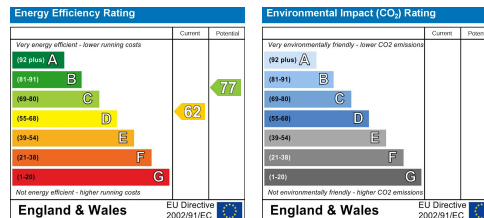

ChaseBuchanan