



**Selbourne Avenue  
Hounslow**

£450,000

**ChaseBuchanan**

## Key Features

- Viewings accompanied by Chase Buchanan
- Two bedroom apartment
- Two bathrooms
- Immaculate condition throughout
- Stunning views
- Hounslow East tube station 8 minute walk away
- Close to Hounslow centre
- Share of freehold

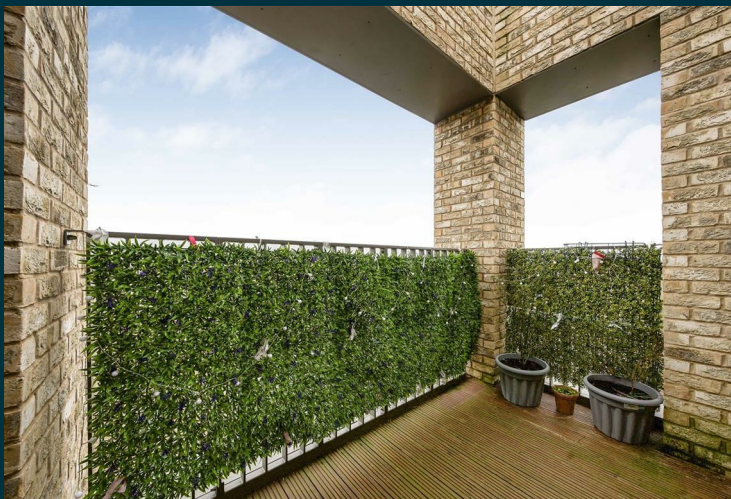

## Description

This immaculately presented and extremely spacious two double bedroom apartment boasting two bathrooms, lift service with reaching views over London and Twickenham. The building was completed in 2020 and is in supreme condition throughout and is offered as Share of Freehold.

The property comprises open plan kitchen/living and dining room with access to balcony making this large area light, bright and airy.

The principal bedroom features an en suite bathroom and two juliet balconies and benefits further from fitted wardrobes and being south facing.

Bedroom two is a large double and comes complete with fitted wardrobes.

The family bathroom is floor to ceiling tiled and comprises of bath/shower, heated towel rail, basin and W.C.

The property has extremely large amount of storage.

The property is only 8-minute walk from Hounslow East Underground Station and less than 5 min walk away from Hounslow bus station, making it ideal for commuters! Heathrow Airport is just 13 minutes away by tube.





# Goodwin House TW3

Approx. Gross Internal Floor Area  
82.0 Sq M - 883 Sq Ft

ChaseBuchanan

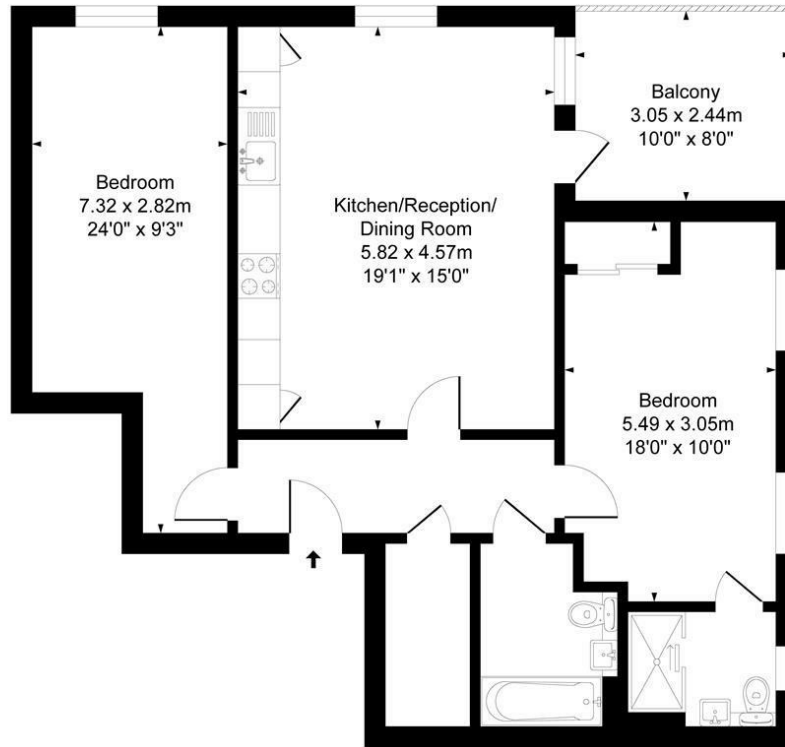

Fifth Floor

Illustration for identification purposes only, measurements are approximate, not to scale.  
Produced By Esjay Property Marketing

For more information or to book a viewing, please contact:

**020 8758 1755**

isleworth@chasebuchanan.london

480 London Road, TW7 4DE

Care has been taken in the preparation of these particulars, however, their accuracy is not guaranteed and they do not form part of any contract. Measurements stated must be considered maximum.

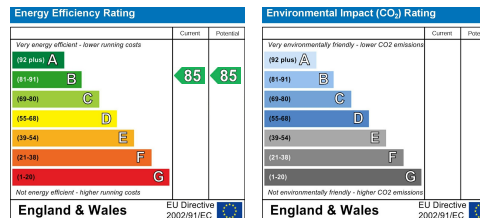

**ChaseBuchanan**