

**St. Johns Road  
Isleworth  
TW7 6GX**

£340,000

**ChaseBuchanan**



# St John's Road

Approx. Gross Internal Floor Area  
52.0 Sq M - 560 Sq Ft

**ChaseBuchanan**

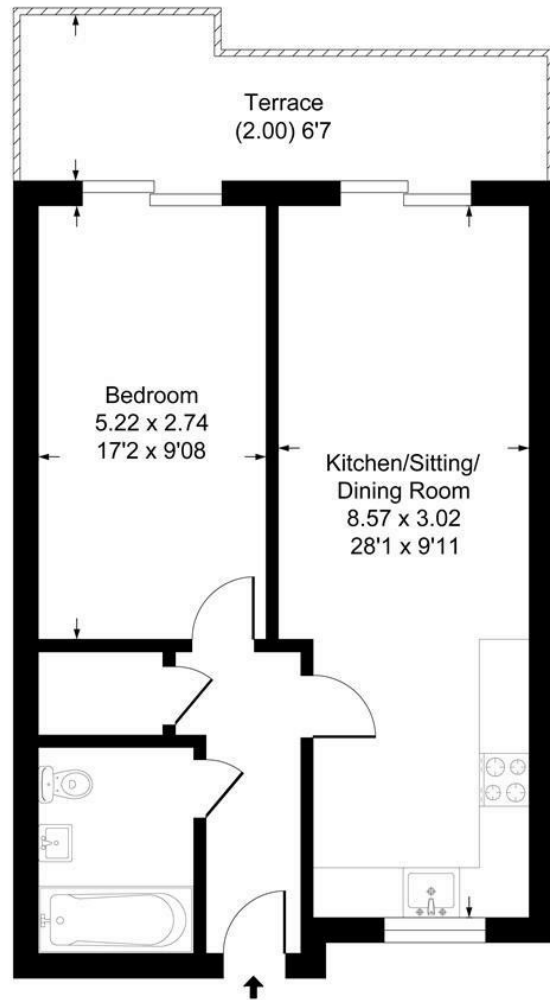

Illustration for identification purposes only, measurements are approximate, not to scale.

Energy Efficiency Rating		Current	Desired
Very energy efficient - lower running costs			
A	92-100	82	82
B	81-91		
C	69-80		
D	55-68		
E	39-54		
F	21-38		
G	1-20		

Environmental Impact (CO <sub>2</sub> ) Rating		Current	Desired
Very environmentally friendly - lower CO <sub>2</sub> emissions			
A	10-19%		
B	20-29%		
C	30-39%		
D	40-49%		
E	50-59%		
F	60-69%		
G	70-79%		

Care has been taken in the preparation of these particulars, however, their accuracy is not guaranteed and they do not form part of any contract. Measurements stated must be considered maximum.

- Viewings accompanied by Chase Buchanan
- Open plan living
- Allocated parking space
- Exclusive gated development
- Top floor penthouse style apartment
- Private terrace
- Lift serviced
- Walking distance of Isleworth Station

A simply stunning and smart penthouse-style apartment, ideally placed in an exclusive modern gated development in the heart of Isleworth.

Located on the top floor of this lift serviced block, the accommodation comprises an expansive open plan kitchen/sitting/dining room with doors to a terrace that stretches across the width of the apartment offering lovely views across the skyline, bedroom with doors out onto the terrace, bathroom and a storage cupboard. Further benefits include an allocated parking space, 121 years left on the lease, and 6 years remaining on the new build warranty.

Located within short walking distance of Isleworth train station with its frequent services into London Waterloo and within easy reach of the river, St Margarets and Richmond, which are also close by.

For more information or to book a viewing, please contact:

**020 8758 1755**

**ChaseBuchanan**

7 Odeon Parade, 480 London Road, Isleworth, Middlesex, TW7 4DE