



**Hunting Place
Hounslow**

£350,000

ChaseBuchanan

Key Features

- Viewings accompanied by Chase Buchanan
- Two double bedroom apartment
- Two bathrooms
- Generous accommodation
- Lift service
- Excellent condition
- Allocated parking
- Quiet location

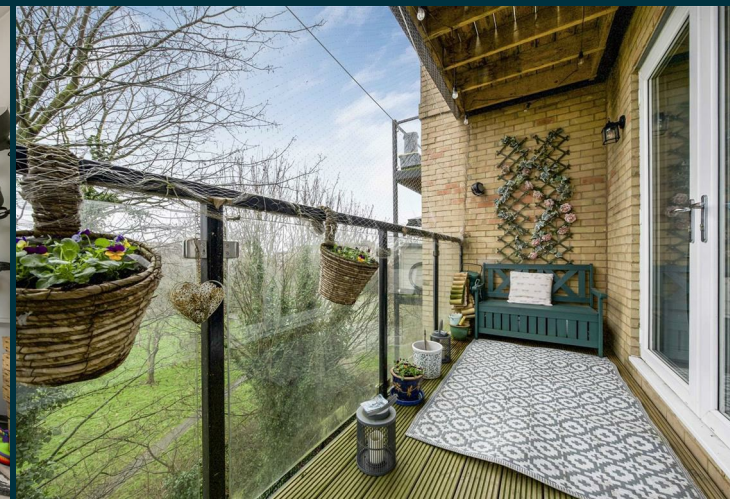

Description

Chase Buchanan are delighted to offer to the market this large two double bedroom, two-bathroom apartment offering superb views over Heston Park.

The property boasts an open plan living/dining room with patio doors leading onto the generous balcony. The kitchen is double aspect with ample high and low storage cupboards and super workspace making the whole area light, bright and airy.

The principal bedroom is a good size with an ensuite bathroom, bedroom two is also large and features access to the balcony. The family bathroom is attractively tiled and very generous.

Additional features include; ample storage, lift service, 117 years lease and one parking space.

Conveniently positioned, the apartment provides easy access to bus links connecting to Hounslow West Station, London Heathrow Airport, and Hounslow town centre with the A4/M4 close by. There are excellent schools and nurseries close by along with local shops and amenities, including Heston Pools and Fitness. The A4/M4 ensures seamless connections to neighbouring towns.





Mayfair Court

Approx. Gross Internal Floor Area
72.1 Sq M - 777 Sq Ft

ChaseBuchanan

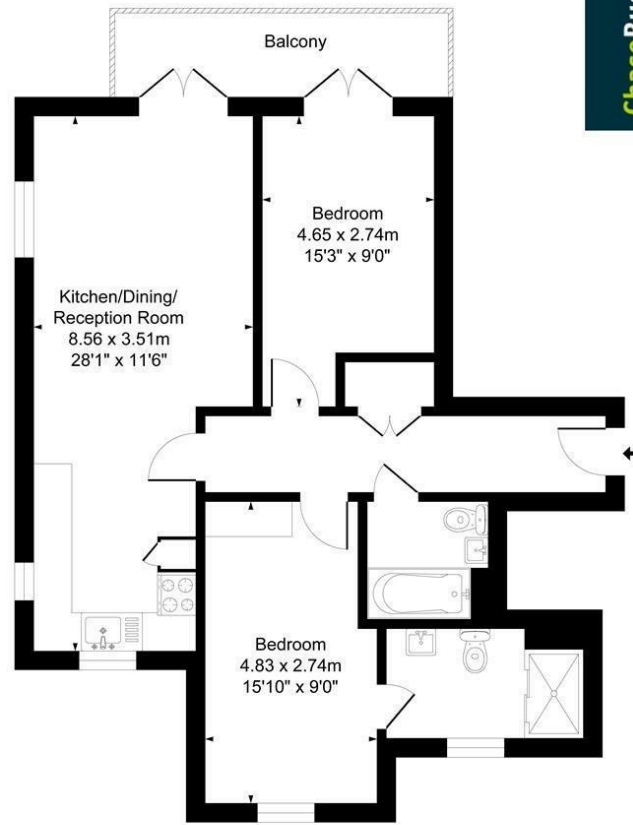

Third Floor

Illustration for identification purposes only, measurements are approximate, not to scale.
Produced By Esjay Property Marketing

Care has been taken in the preparation of these particulars, however, their accuracy is not guaranteed and they do not form part of any contract. Measurements stated must be considered maximum.

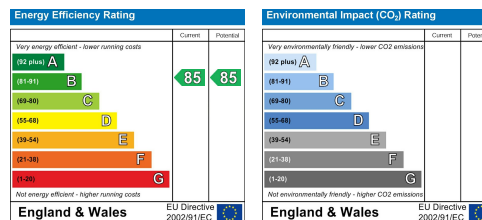

For more information or to book a viewing, please contact:

020 8758 1755

isleworth@chasebuchanan.london

480 London Road, TW7 4DE

ChaseBuchanan