

Roundcroft, West Cheshunt



**** CHAIN FREE ** A SUPERB THREE/FOUR BEDROOM, TWO RECEPTION ROOM, TWO BATHROOM, SEMI-DETACHED FAMILY HOME, IN A SOUGHT AFTER LOCATION, WITH SOUTH FACING GARDEN & HIGHLY REGARDED SCHOOLING CLOSE BY ****
A well presented THREE/FOUR bedroom, TWO reception room, semi-detached family home, situated in a highly desirable turning on the hugely popular Adamsfield development. This fine family home has been lovingly cared for by the current owners complemented by bright and airy interiors through out. The versatile accommodation has been arranged over two floors and comprises: 17'3 X 14'1 LOUNGE, 19'6 X 7'5 RECEPTION ROOM / GUEST BEDROOM with SHOWER ROOM (formerly garage) and a 17'3 x 10'4 KITCHEN / BREAKFAST ROOM. On the first floor, there are three well proportioned bedrooms and a family bathroom. Outside the established gardens enjoy a southerly aspect and have been mainly laid to lawn. To the front is a decorative brick paved driveway providing off road parking. Roundcroft is ideally situated on the western fringes of Cheshunt, with fine country walks, recreational parkland and highly regarded schooling close by. Cuffley Village with its excellent transport links to London's Kings Cross & Moorgate is approximately 2 miles.

Property Price £500,000



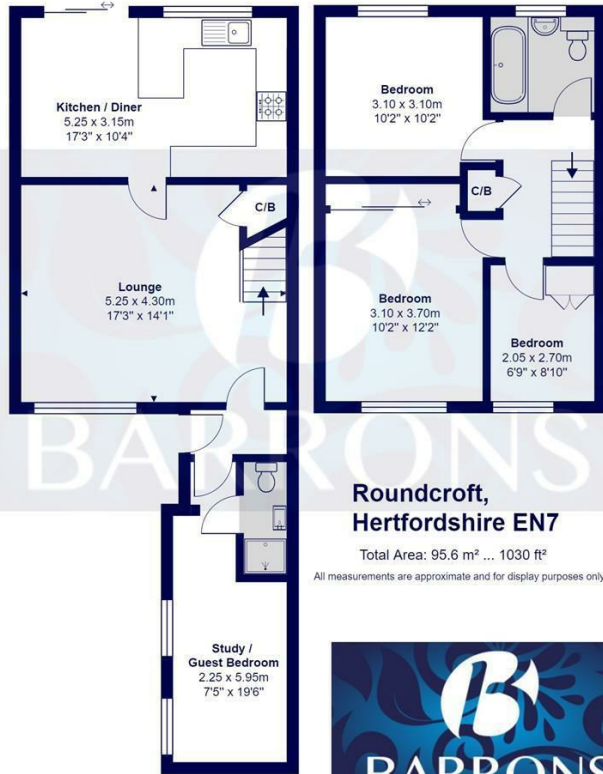

- THREE/FOUR BEDROOM FAMILY HOME
- 17'3 X 14'1 LOUNGE
- 19'6 X 7'5 RECEPTION ROOM / GUEST BEDROOM (formerly garage)
- 17'3 x 10'4 KITCHEN / BREAKFAST ROOM
- GROUND FLOOR SHOWER ROOM
- 12'2 X 10'2 MASTER BEDROOM
- FAMILY BATHROOM
- WELL PRESENTED THROUGHOUT
- SOUTH FACING GARDEN
- OFF ROAD PARKING

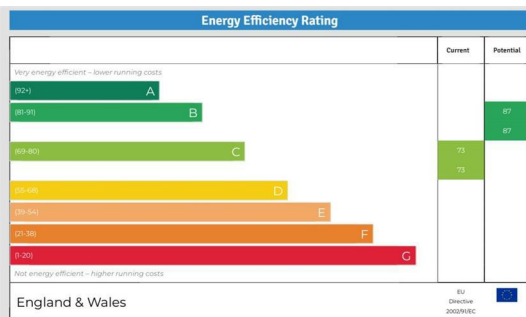

- Extensive local knowledge • Professional personal service • Full colour property particulars • Bespoke Marketing
- Major Website Portals • 24 Hour feedback pledge • Latest Technology

25 The Old Building, Bishops College, Churchgate, Hertfordshire, EN8 9XQ • t: 01707 877808 • t: 01992 845 842 • www.barronsresidential.co.uk



Disclaimer: "these property particulars, including floor plans, are set out as a general outline only for guidance and do not constitute any part of an offer or contract. Please note that all measurements above have been taken with a sonic tape measure and therefore may be subject to a small margin of error. A buyer is advised to obtain verification from their solicitor or surveyor. The agent has not tested any apparatus, equipment, fixture and fittings or services and therefore cannot verify that they are in working order or fit for the purpose" All enquiries and negotiations must be carried out through Barrons Residential.