



Cedar Apartments | North Street | CO10 1RE

£700 pcm

* NO TENANT FEES * ZERO DEPOSIT SCHEME AVAILABLE - STUNNING LUXURY APARTMENTS within Sudbury's town centre complete with open plan lounge and kitchen with all kitchen appliances built in, high spec fixtures and fittings, shower room, views over Sudbury's chimney tops and an allocated parking space. Various apartments are available to let, so please call BYCHOICE to arrange your viewing tour.

- Luxury Apartments
- One Bedroom
- Open Plan Lounge / Diner / Kitchen
- Second Floor
- Lift Access
- Views Over Sudbury
- Allocated Parking

ENTRANCE HALL Secure entrance system

CUPBOARD Containing water tank, some storage space

BATHROOM 7' 8" x 8' 11" (2.34m x 2.72m) Low level WC enclosed within white high gloss finish vanity unit with large basin, shower cubicle with sliding screen, wall mounted mirrored medicine cabinet

BEDROOM 9' 8" x 8' 11" (2.95m x 2.72m) UPVC double glazed window, wall mounted electric radiator

OPEN PLAN LOUNGE & KITCHEN 15' 8" x 15' 5" (4.8m x 4.7m) The lounge area offers double aspect UPVC windows creating a wealth of natural light

The kitchen has light grey high gloss matching wall and base units with work surface over, sink with drainer, integrated four ring hob, with extractor hood over, integrated electric oven, built in fridge and freezer, built in washing machine

PARKING One allocated parking space is offered with the apartment, at the underground residents parking area

Agents Note *(All fees are inclusive of VAT)*

- Excellent references will be required by anyone renting through Bychoice
- A deposit equal to five weeks rent will be required
- A holding deposit equal to one weeks rent will be required on application
- Tenants will be required to provide their own contents insurance

Local Authority – Babergh District Council
 Council Tax Band – To be confirmed
 Post Code – CO10 1RE
 Please Note – No pets, no smokers, no housing benefits

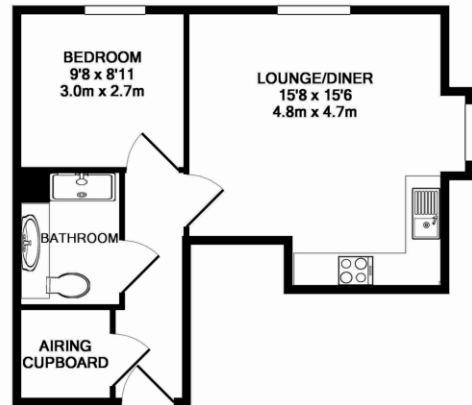

Whilst every attempt has been made to ensure the accuracy of the floor plan contained here, measurements of doors, windows, rooms and any other items are approximate and no responsibility is taken for any error, omission, or mis-statement. This plan is for illustrative purposes only and should be used as such by any prospective purchaser. The services, systems and appliances shown have not been tested and no guarantee as to their operability or efficiency can be given
 Made with Metropix ©2019

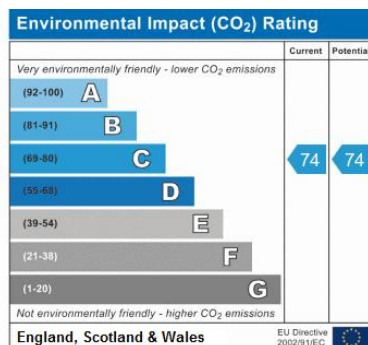
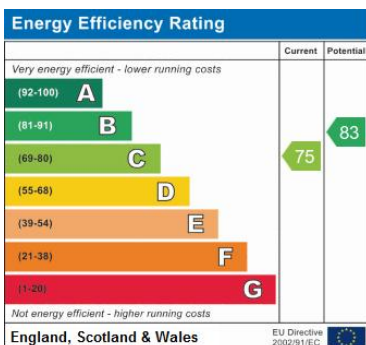

Contact Details

6 King Street, Sudbury, Suffolk, CO10 2EB

Tel: 01787 468400

Email: sudbury@bychoice.co.uk

Agents Note: Whilst every care has been taken to prepare these sales particulars, they are for guidance purposes only. All measurements are approximate are for general guidance purposes only and whilst every care has been taken to ensure their accuracy, they should not be relied upon and potential buyers are advised to recheck the measurements

