

**FOR SALE**



**Duncannon Drive, Falmouth**  
**Guide Price £265,000**

  
**MARTIN&CO**

# Duncannon Drive, Falmouth

Guide Price £265,000

- DETACHED BUNGALOW
- TWO DOUBLE BEDROOMS
- GARAGE AND PARKING
- ELEVATED VIEWS
- CHAIN FREE

*Detached two double-bedroom bungalow with garage and parking, lovely elevated views to the front and located in this sought after residential neighbourhood.*

Duncannon Drive is a sought-after residential neighbourhood which offers easy access to Penmere railway station, beaches, parks, and the town centre.

Detached two double-bedroom bungalow with garage and parking with elevated views to the front located in this sought after residential neighbourhood. The property has been a successful rental for several years and is now being sold chain free.

The living room is light and spacious with a feature fireplace and has some lovely far reaching views to the front aspect. Both bedrooms are generous in size and overlook the rear garden.



The kitchen again has lovely views to the front aspect, wall and base units with space for appliances.

Shower room has tiled flooring, WC, wash hand basin and a walk in shower cubicle with wall mounted electric Mira shower and window to side aspect.

Outside

Garage and driveway parking.

Front garden is laid to lawn. The rear garden has a patio area with a greenhouse, steps lead from the patio to a further area of garden again with far reaching views and a raised decked area being ideal to sit out and entertain.

Council Tax band C

EPC E

Chain Free

### LOCATION

Falmouth is a charming coastal town and a popular destination renowned for its maritime heritage, beautiful scenery, and vibrant atmosphere. Situated on the south coast of Cornwall, Falmouth boasts stunning beaches, scenic coastal walks, and a picturesque harbour.

Falmouth is home to the renowned National Maritime Museum Cornwall, which offers fascinating exhibits on the region's maritime history and global seafaring heritage.

The town also hosts various festivals and events throughout the year, including the Falmouth Week sailing regatta and the Falmouth Oyster Festival to name just a few.

With its lively waterfront, quaint streets lined with shops and galleries, and an array of restaurants serving fresh seafood, Falmouth offers a delightful mix of seaside charm and cultural attractions. It's an ideal destination for anyone seeking relaxation, adventure, or a taste of Cornwall's rich maritime culture.



Approx Gross Internal Area  
56 sq m / 606 sq ft

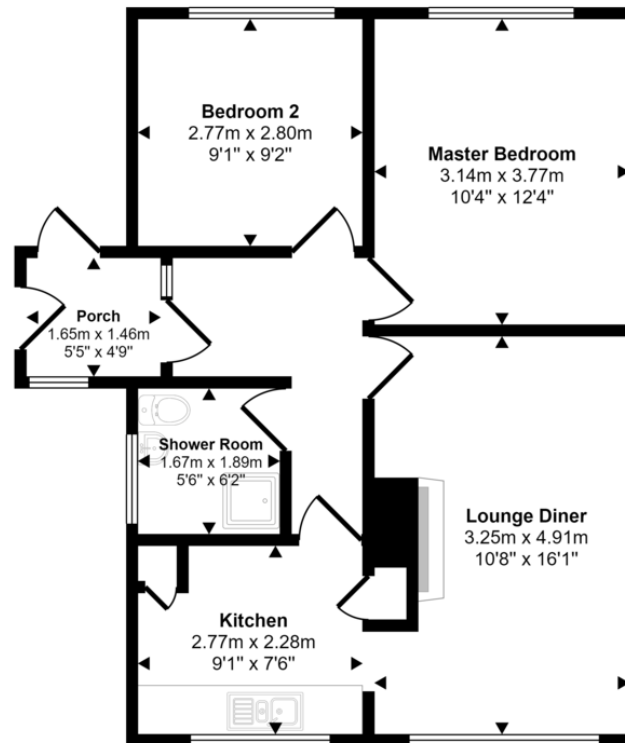

Floorplan

This floorplan is only for illustrative purposes and is not to scale. Measurements of rooms, doors, windows, and any items are approximate and no responsibility is taken for any error, omission or mis-statement. Icons of items such as bathroom suites are representations only and may not look like the real items. Made with Made Snappy 360.

## Martin & Co Falmouth

72 Kimberley Park Road • Falmouth • TR11 2DF  
T: 01326 697696 • E: falmouth@martinco.com

01326 697696

<http://www.martinco.com>

**MARTIN&CO**

**Accuracy:** References to the Tenure of a Property are based on information supplied by the Seller. The Agent has not had sight of the title documents. A Buyer is advised to obtain verification from their Solicitor. Items shown in photographs including but not limited to carpets, fixtures and fittings are not included unless specifically mentioned within the sales particulars. They may however be available by separate negotiation. Buyers must check the availability of any property and make an appointment to view before embarking on any journey to see a property. No person in the employment of the agent has any authority to make any representation about the property, and accordingly any information given is entirely without responsibility on the part of the agents, sellers(s) or lessors(s). Any property particulars are not an offer or contract, nor form part of one. **Sonic / Laser Tape:** Measurements taken using a sonic / laser tape measure may be subject to a small margin of error. **All Measurements:** All Measurements are Approximate. **Services Not tested:** The Agent has not tested any apparatus, equipment, fixtures and fittings or services and so cannot verify that they are in working order or fit for the purpose. A Buyer is advised to obtain verification from their Solicitor or Surveyor.