

**FOR SALE**



**Barn Conversion & Development Opportunity**  
**Guide Price £525,000**

  
**MARTIN&CO**

# Barn Conversion & Development Opportunity

Guide Price £525,000

- PLANNING PERMISSION
- APPROX 1 ACRE OF LAND
- STUNNING VIEWS

**ONE BEDROOM CONVERTED BARN WITH PLANNING TO CONVERT A LARGER BARN INTO A 4 BEDROOM FAMILY HOME + 1 ACRE OF LAND**

ONE BEDROOM CONVERTED BARN WITH PLANNING TO CONVERT A LARGER BARN INTO A 4 BEDROOM FAMILY HOME.

A rare opportunity to purchase a part completed development project of two stunning stone barns set in close to an acre of land and surrounded by astounding countryside.

The conversion of the smaller barn into a one bedroom single storey property has recently been completed to an exceptional standard and features a brand-new roof, beautifully pointed stonework, double glazed windows, a vaulted ceiling and quality fittings throughout.



The larger barn (actually two adjoining barns) has detailed planning permission to be converted into a 3 / 4 bedroom double storey main residence. (Planning no: PA18/ 04540)

Additional features of the development project are;  
 A recently completed detached double garage with useful loft room above.  
 Extensive driveway with ample parking and turning area.  
 Raised terrace with a 28ft caravan in situ, ideal for housing builders working on the property.  
 Fully enclosed, gently sloping expanse of lawn in front of the property with a variety of fruit trees, a poly tunnel, vegetable plots and a log store.  
 Stone building materials already on-site to be used in the development.  
 Breathtaking countryside views all around.

Altogether this is a wonderful and exciting development opportunity for someone looking to create their own rural idyll in the heart of the Cornish countryside. Viewing is essential!

To view the planning application / permission please copy and paste the following into your browser:  
<https://planning.cornwall.gov.uk/online-applications/applicationDetails.do?activeTab=documents&keyVal=P8Q8PTFGJN100>

| Score | Energy rating | Current | Potential |
|-------|---------------|---------|-----------|
| 92+   | A             |         | 97 A      |
| 81-91 | B             |         |           |
| 69-80 | C             |         |           |
| 55-68 | D             |         |           |
| 39-54 | E             | 48 E    |           |
| 21-38 | F             |         |           |
| 1-20  | G             |         |           |



Approx Gross Internal Area  
50 sq m / 534 sq ft

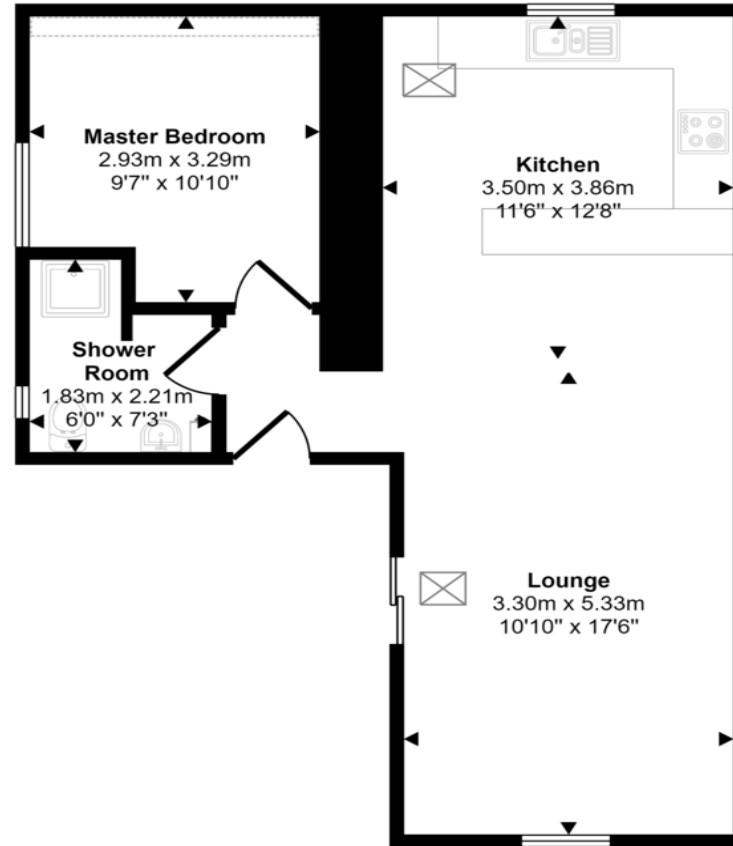

## Martin & Co Falmouth

72 Kimberley Park Road • • Falmouth • TR11 2DF  
T: 01326 697696 • E: falmouth@martinco.com

**01326 697696**  
<http://www.martinco.com>



**Accuracy:** References to the Tenure of a Property are based on information supplied by the Seller. The Agent has not had sight of the title documents. A Buyer is advised to obtain verification from their Solicitor. Items shown in photographs including but not limited to carpets, fixtures and fittings are not included unless specifically mentioned within the sales particulars. They may however be available by separate negotiation. Buyers must check the availability of any property and make an appointment to view before embarking on any journey to see a property. No person in the employment of the agent has any authority to make any representation about the property, and accordingly any information given is entirely without responsibility on the part of the agents, sellers(s) or lessors(s). Any property particulars are not an offer or contract, nor form part of one. **Sonic / laser Tape:** Measurements taken using a sonic / laser tape measure may be subject to a small margin of error. **All Measurements:** All Measurements are Approximate. **Services Not tested:** The Agent has not tested any apparatus, equipment, fixtures and fittings or services and so cannot verify that they are in working order or fit for the purpose. A Buyer is advised to obtain verification from their Solicitor or Surveyor.