



POYNDERS ROAD, SW4

£380,000

- Purpose built
- Two double bedrooms
- Central location

- Well maintained
- Chain Free
- Energy rating: C



2



1



1



ABOUT THE HOME

A spacious two bedroom purpose built apartment located a short distance away from Clapham Common. The flat benefits from a private balcony and is sold with no onward chain.

Poynders Court is within a short walk of Clapham Common and Clapham South underground station, whilst many bus routes pass almost just outside the building. In addition the boutique shops, bars and restaurants of Abbeville Village are also nearby.





Second Floor

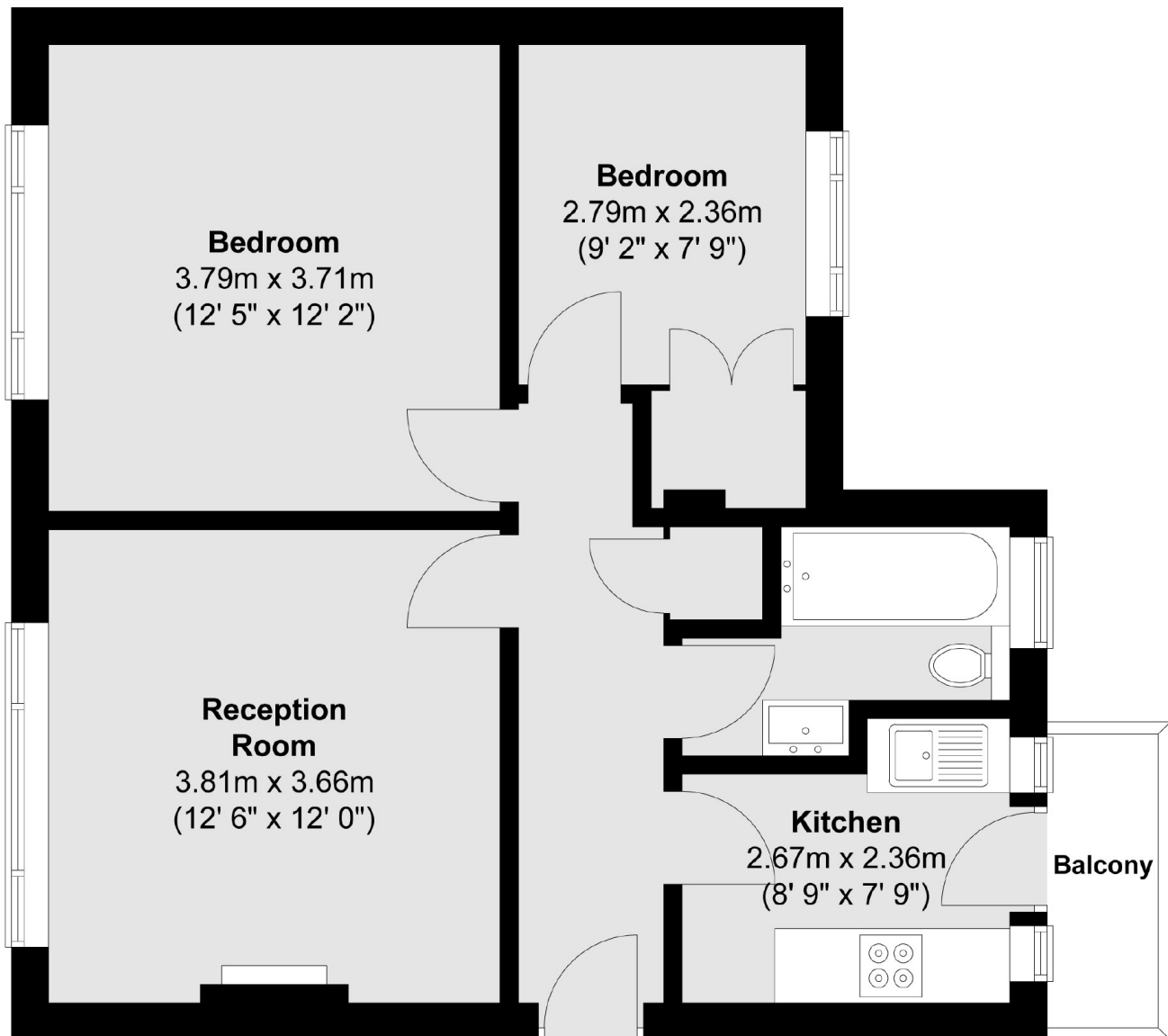

Total area (approx.) : 55.9 sq. m (602 sq. ft)
 Total balcony area (approx.) : 2.1 sq. m (23 sq. ft)

JACKSONS CLAPHAM

73 Abbeville Road, London,
 SW4 9JN
 Sales: 020 8487 3177
 Lettings: 020 8487 3178

Energy Rating: C We aim to make our particulars both accurate and reliable. However they are not guaranteed; nor do they form part of an offer or contract. If you require clarification on any points then please contact us, especially if you're traveling some distance to view. Please note that appliances and heating systems have not been tested and therefore no warranties can be given as to their good working order.