



WEST ROAD, SW4

£5,500 PCM

- End of terrace
- Four bedrooms
- Kitchen breakfast room
- Large private garden
- Off-street parking
- Energy rating: B





ABOUT THE HOME

A beautifully presented four bedroom family home with two bathrooms and off-street parking, perfect for a couple or a family.

The house is arranged over three floors, with the ground floor offering a great entertainment space. The first and second floors comprise of four generous size bedrooms, a family bathroom and a further en-suite. To the rear is a lovely south facing garden.

West Road is conveniently located for the shops, restaurants and cafés of Abbeville Village. Clapham Common, Clapham North and even Brixton stations are also close by.





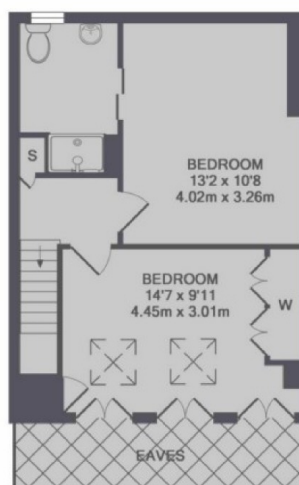

2ND FLOOR



GROUND FLOOR



1ST FLOOR

TOTAL APPROX. FLOOR AREA 1472 SQ.FT. (136.7 SQ.M.)

JACKSONS CLAPHAM

73 Abbeville Road, London,

SW4 9JN

Sales: 020 8487 3177

Lettings: 020 8487 3178

Energy Rating: We aim to make our particulars both accurate and reliable. However they are not guaranteed; nor do they form part of an offer or contract. If you require clarification on any points then please contact us, especially if you're traveling some distance to view. Please note that appliances and heating systems have not been tested and therefore no warranties can be given as to their good working order.