



LANDOR ROAD, SW9

£525,000

- Split level
- Period conversion
- Three bedrooms
- Excellent transport links
- Shared outside space
- Energy rating: C





ABOUT THE HOME

This well presented three-bedroom split-level period conversion offers a modern finish across thoughtfully arranged living space. Set over the first and second floors, it features a bright open-plan reception room and kitchen with integrated appliances and tall sash windows. The first floor features the large principal bedroom with en suite bathroom, while the second floor comprises two double bedrooms and a stylish family bathroom. Built-in storage provides added practicality throughout. The property also benefits from access to shared outside space.

Landor Road is located between Clapham and Brixton and offers easy access to local shops, cafés and bars. Clapham High Street and Brixton are within walking distance, with Clapham North Underground (0.3 miles), Stockwell (0.5 miles) and Clapham High Street Overground (0.3 miles) providing excellent transport links.





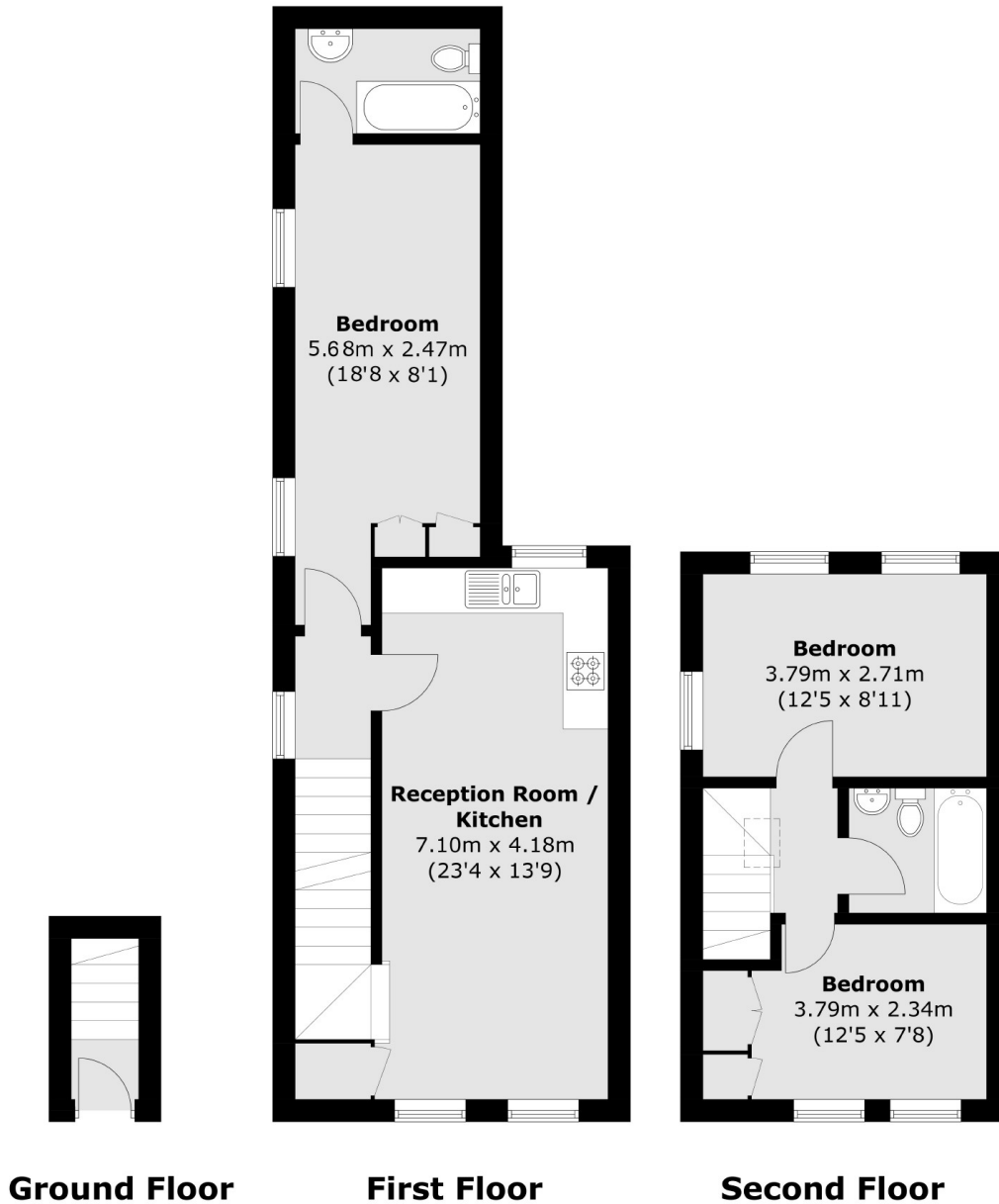

Total area (approx.): 76.1 sq. m (819.1 sq. ft)

JACKSONS CLAPHAM

73 Abbeville Road, London,
SW4 9JN
Sales: 020 8487 3177
Lettings: 020 8487 3178

Energy Rating: C We aim to make our particulars both accurate and reliable. However they are not guaranteed; nor do they form part of an offer or contract. If you require clarification on any points then please contact us, especially if you're traveling some distance to view. Please note that appliances and heating systems have not been tested and therefore no warranties can be given as to their good working order.