



LYHAM ROAD, SW2

£2,650 PCM

- Town house
- High specification
- Two bedrooms

- Brixton Hill area
- Private garden
- Energy rating: C







## ABOUT THE HOME

A beautiful two story town house offering a large open plan kitchen reception room, two double bedrooms, modern bathroom and private garden. The property would be perfect for a couple.

Lyham Road is well connected to Clapham Common, Clapham North and Brixton tube stations. It also provides easy access to Abbeville Village and all the bars and restaurants around Clapham and Brixton.







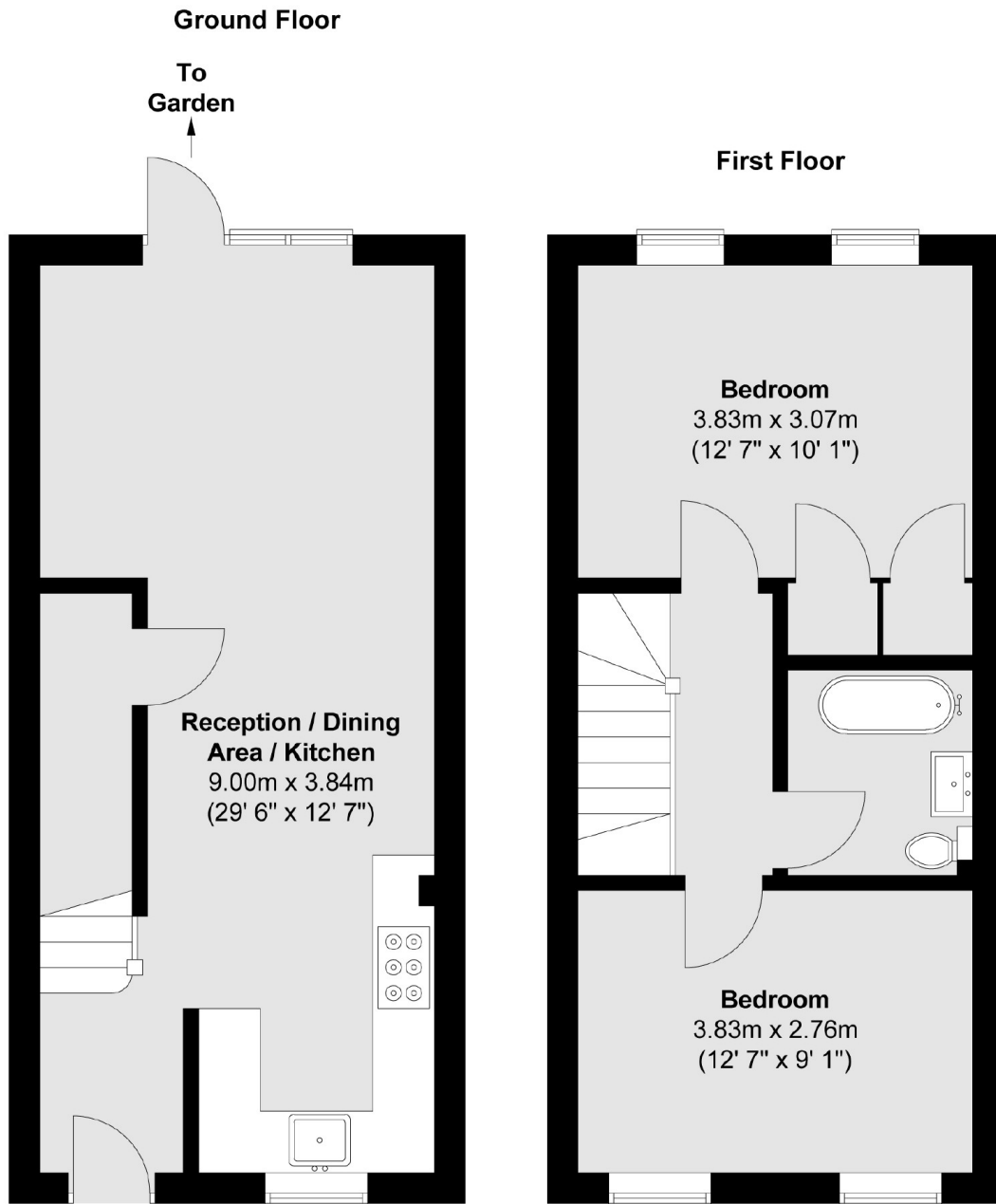

Total area (approx.) : 68.7 sq. m (739 sq. ft)

#### **JACKSONS CLAPHAM**

73 Abbeville Road, London,  
SW4 9JN  
Sales: 020 8487 3177  
Lettings: 020 8487 3178

Energy Rating: C We aim to make our particulars both accurate and reliable. However they are not guaranteed; nor do they form part of an offer or contract. If you require clarification on any points then please contact us, especially if you're traveling some distance to view. Please note that appliances and heating systems have not been tested and therefore no warranties can be given as to their good working order.