



Tilson Gardens, SW2

£2,150 PCM

Modern three bedroom ground floor flat ideally located between Brixton and Clapham comprising open plan reception/dining room, three double bedrooms, fitted kitchen and bathroom with shower

- Three Double Bedrooms
- One Reception
- Modern Kitchen
- Bathroom With Shower
- Ground Floor
- 0.8 Miles From Clapham South

For further information on the costs associated with renting a property, please pop into our office or visit our website.



Tilson Gardens is located 0.8 miles from Clapham South underground station providing access to the Northern Line.



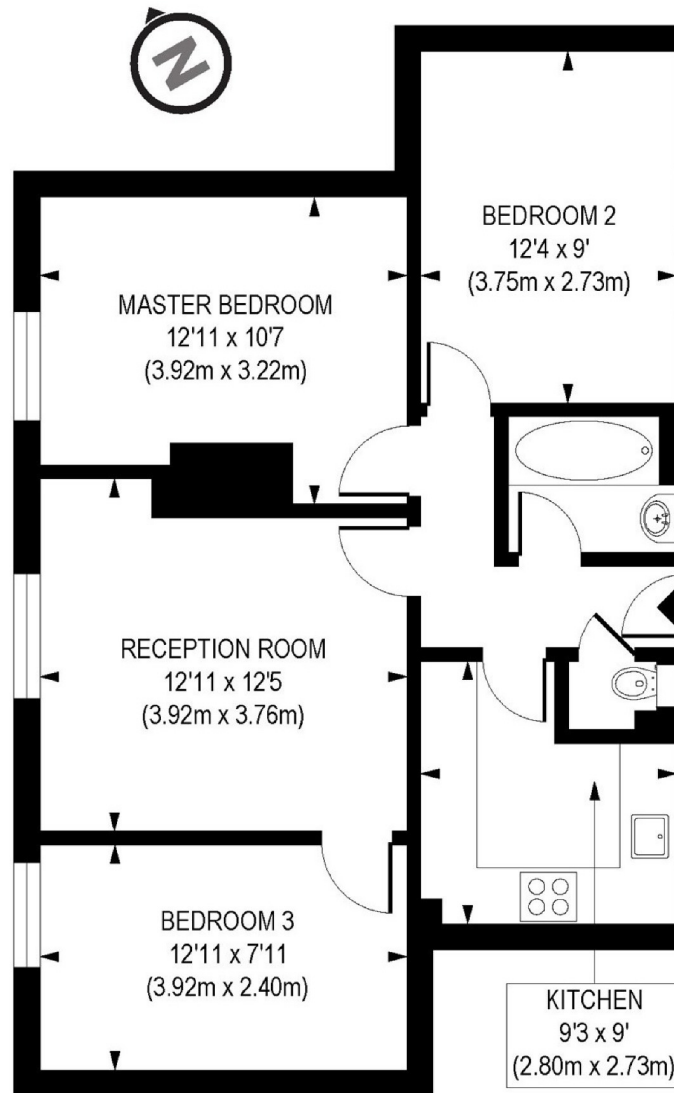

Floorplan is for illustrative purposes only and is not to scale.
Every attempt has been made to ensure the accuracy of the floorplan shown, however all measurements, fixtures, fittings and data shown are an approximate interpretation for illustrative purposes only.
Liability for errors, omissions or mis-statement through negligence or otherwise is hereby excluded.

Jacksons Clapham
73 Abbeville Road
London
SW4 9JN
020 8875 7995
clapham.lettings@jacksonsestateagents.com

Energy Rating: B We aim to make our particulars both accurate and reliable. However they are not guaranteed; nor do they form part of an offer or contract. If you require clarification on any points then please contact us, especially if you're traveling some distance to view. Please note that appliances and heating systems have not been tested and therefore no warranties can be given as to their good working order.