



ARBORFIELD CLOSE, SW2

£575,000

- Terraced House
- South Facing Development
- Private Road
- Off Street Parking
- Close To Tulse Hill Station
- Energy rating: C





ABOUT THE HOME

A charming three bedroom terraced property in a private development. The property has been well maintained by current owners and benefits from a south facing garden.

Arborfield Close is a private road located just off Palace Road on the borders of Streatham Hill and Tulse Hill. Residents have easy access to a wealth of amenities including an array of shops, bars and restaurants on Streatham High Road & West Norwood High Street. There are a number of transport options including the CityThameslink via Tulse Hill, Streatham Hill Station and a number of bus routes into the City via Brixton.





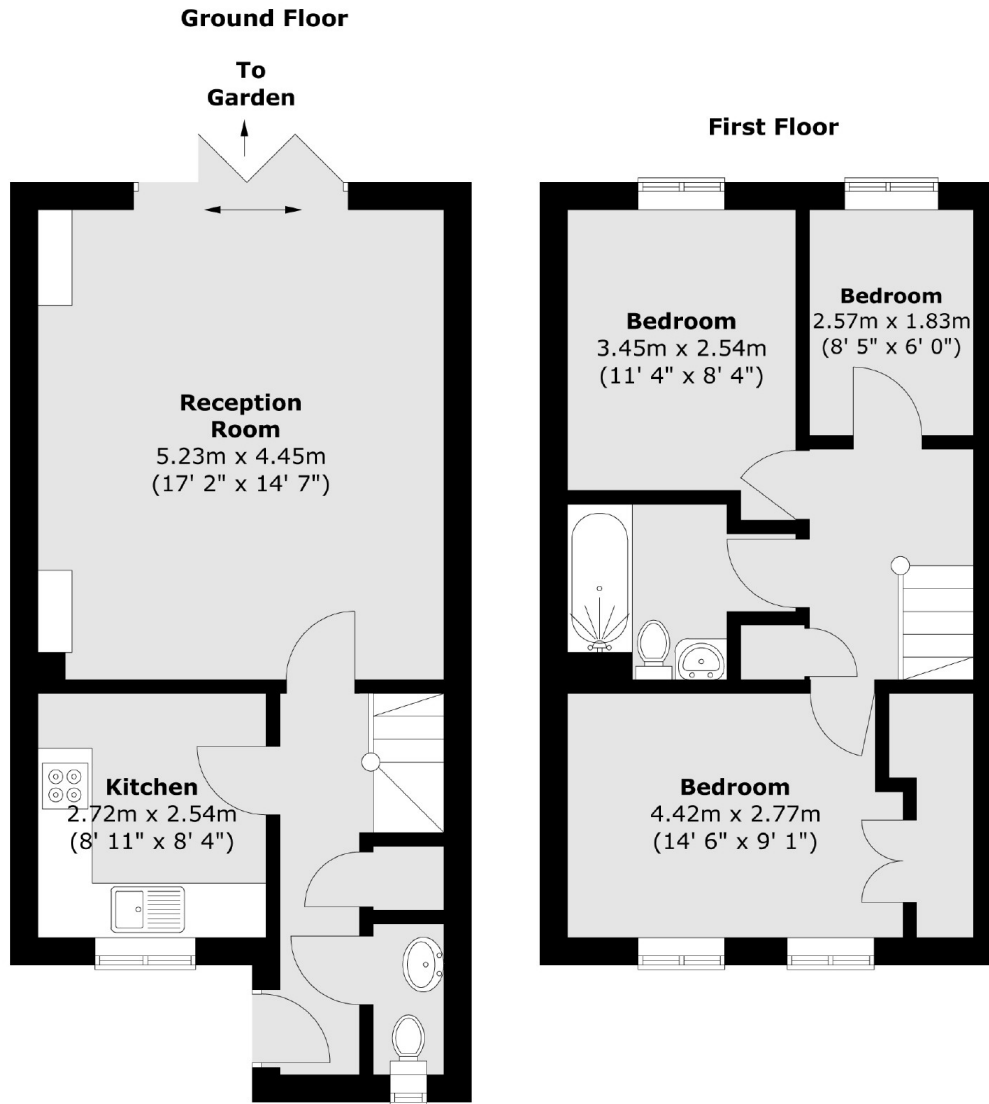

Total area (approx.) : 76.8 sq. m (826 sq. ft)

JACKSONS CLAPHAM

73 Abbeville Road, London,

SW4 9JN

Sales: 020 8487 3177

Lettings: 020 8487 3178

Energy Rating: C We aim to make our particulars both accurate and reliable. However they are not guaranteed; nor do they form part of an offer or contract. If you require clarification on any points then please contact us, especially if you're traveling some distance to view. Please note that appliances and heating systems have not been tested and therefore no warranties can be given as to their good working order.