



## Park Hill, SW4

£775,000

A spacious three bedroom ground floor Victorian maisonette on a popular road in Abbeville Village. The property benefits from a side and front garden and is sold with no onward chain.

- Victorian Property
- Ground Floor Maisonette
- Three Bedrooms
- Share Of Freehold
- No Onward Chain
- Central Location





Park Hill is considered to be a sought after road in Abbeville Village, representing a minority of residential roads that showcase a wide range of architectural property designs. Residents have easy access to the array of independent shops, pubs and restaurants of both Abbeville Road, Clapham Old Town and the ever popular Clapham Common. The nearest tube station is Clapham Common Underground (Northern Line), located 0.4 miles away in addition to a number of regular bus routes into the City and West End.





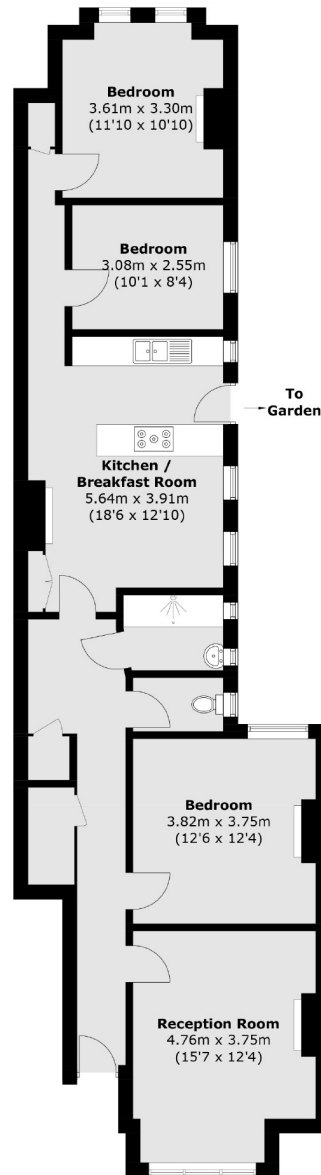

Total area (approx.): 99.7 sq. m (1,073.1 sq. ft)

Jacksons Clapham  
73 Abbeville Road  
London  
SW4 9JN  
020 8875 7995  
[clapham.sales@jacksonsstateagents.com](mailto:clapham.sales@jacksonsstateagents.com)

Energy Rating: C We aim to make our particulars both accurate and reliable. However they are not guaranteed; nor do they form part of an offer or contract. If you require clarification on any points then please contact us, especially if you're traveling some distance to view. Please note that appliances and heating systems have not been tested and therefore no warranties can be given as to their good working order.