

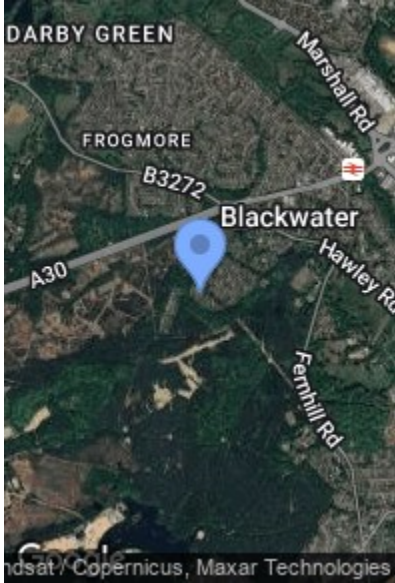

ROAD MAP



HYBRID MAP



TERRAIN MAP



QUEENSBURY PLACE, BLACKWATER, CAMBERLEY GU17

£1,250 PCM

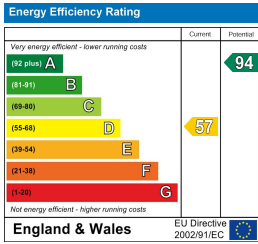

1

1

1





MAIN FEATURES

- Available 5th September
- Unfurnished/Part Furnished
- Front Garden
- One Double Bedroom House
- Two Allocated Parking Spaces
- Close To Yateley Common

FULL DETAILS

Entrance Hallway

Enter via door, cupboard, laminate flooring and stairs leading to the first floor.

Living Room

11'4 x 10'8 (3.45m x 3.25m)

Front aspect and laminate flooring.

Kitchen

10'8 x 8'5 (3.25m x 2.57m)

Range of base and eye level units, four ring induction hob, extractor fan, oven, washing machine, fridge, freezer, sink, partly tiled walls and tiled flooring.

First Floor Landing

Cupboard and carpet flooring.

Bedroom

11'3 x 10'8 (3.43m x 3.25m)

Double bedroom, cupboard and carpet flooring.

Bathroom

Bath with shower, low level WC, wash hand basin with storage below, partly tiled walls and tiled flooring.

To The Front

Mainly laid to lawn with path leading to the door. Access to the store.

Council Tax

Band C.

FLOORPLAN

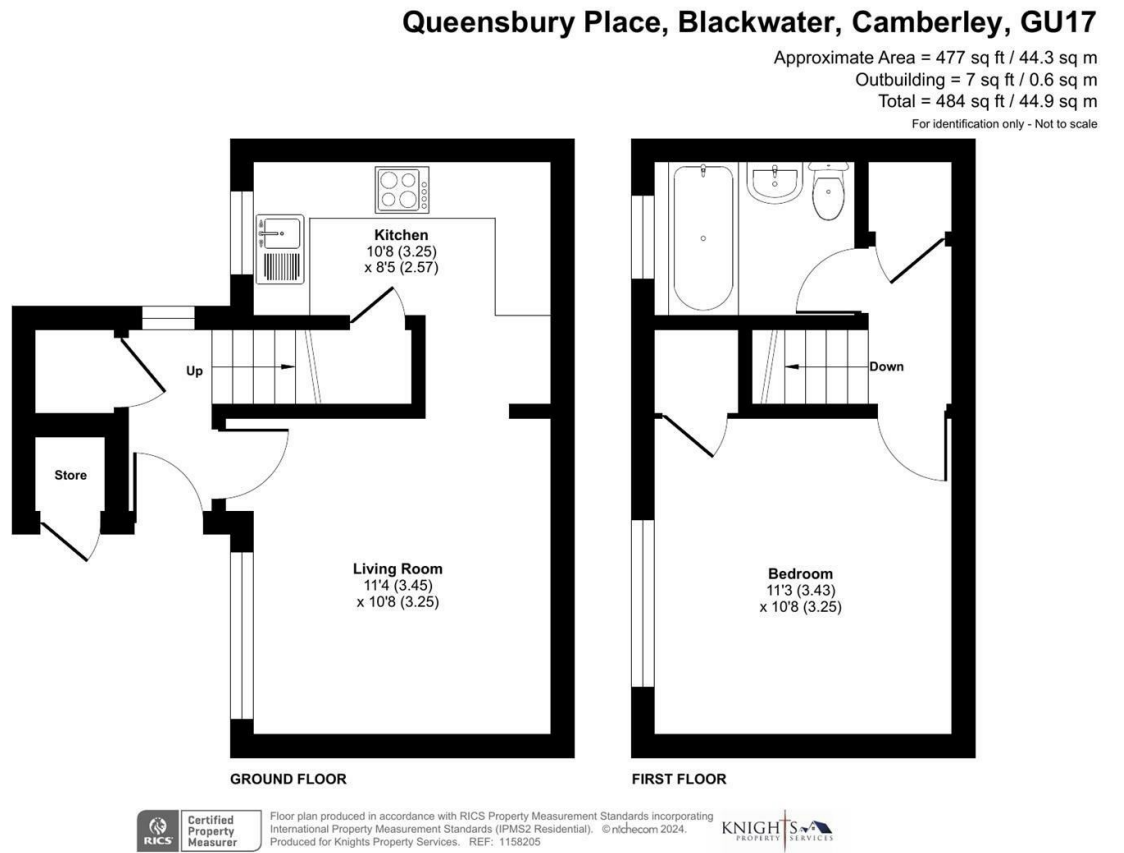

QUEENSBURY PLACE, BLACKWATER, CAMBERLEY GU17

KNIGHTS PROPERTY SERVICES **AVAILABLE 5TH SEPTEMBER AND UNFURNISHED/PART FURNISHED** For rent is this one bedroom house on the Hawley Hill development. The property comprising; living room, kitchen, bathroom and one large double bedroom. As well as allocated parking for two cars, there is also a good-size front garden. The home is situated for good commuter links, as well as being close to The Meadows shopping centre.

Holding deposit - £288.46

5 weeks deposit - £1442.31

Minimum household income required for referencing - £37,500